

# LEGEND

Final surface contours based on A.H.D. datum at an interval of 0.5m, shown as: 9.5

Where applicable, areas to be filled are shown as:

Depth of fill, in metres, shown as:- +

Retaining wall and retaining wall height, shown on the lower side of the wall, have been drawn from data supplied by Arcadis and shown as: (1.2)

Double retaining wall and retaining wall height, shown on the lower side of the wall, have been drawn from data supplied by Arcadis and shown as: (1.2)



**BRENTWOOD  
STAGE 13**  
For  
**AVID Property Group**

**IMPORTANT NOTES:**  
(These notes are an integral part of this plan)  
This plan has been prepared for AVID Property Group for the purposes of a Disclosure Plan Under the Land Sales Act 1984 (as amended).  
It is not to be used by any other person or corporation or for any other purposes and is subject to the following limitations:

Please refer to the approved Development Application for conditions relating to the LOT and to approved Operational Works drawings for services location and possible easements.

**THESE DESIGNS AND DRAWINGS ARE COPYRIGHT AND ARE NOT TO BE USED OR REPRODUCED WITHOUT THE WRITTEN PERMISSION OF VERIS**

**Data Sources**  
Cadastral Boundaries: 400891-001-LC01 Master (L).dwg  
Engineering Design: xc-09c-opw-aa006817-de-DesignBase.dwg  
Final Surface Contours: Brentwood overall design tin.dwg  
Pre-development Surface: 400891-813 DS01(A).dwg  
Retaining Walls: xc-09c-opw-aa006817-de-DesignBase for disclosures.dwg

Issue	Revisions	Date	Drawn
A	Original	24/08/2021	GJF

Locality: Bellbird Park  
Local Authority: Ipswich C. C.  
Horizontal Meridian: MGA Zone 56  
Vertical Level Datum: AHD D  
Scale: 1:250 @ A4  
Designed: Veris  
Drawn: GJF 24/08/2021  
Checked: KJJ 27/08/2021  
Plot Date: 27 Aug, 2021  
Comp File Ref: 400891-St13-DP(A).dwg

**DISCLOSURE PLAN**  
of Proposed LOT 202  
currently being part of  
Lot 512 on SP290298  
( At time of Settlement being part of Lot 512 on SP330346)



BRISBANE (07) 3666 4700 WHITSUNDAYS (07) 4945 6600  
MACKAY (07) 4957 9700 CAIRNS (07) 4252 9400

veris.com.au  
ACN 615 735 727  
Veris Australia Pty Ltd

Drawing No 400891-DP202 Issue A

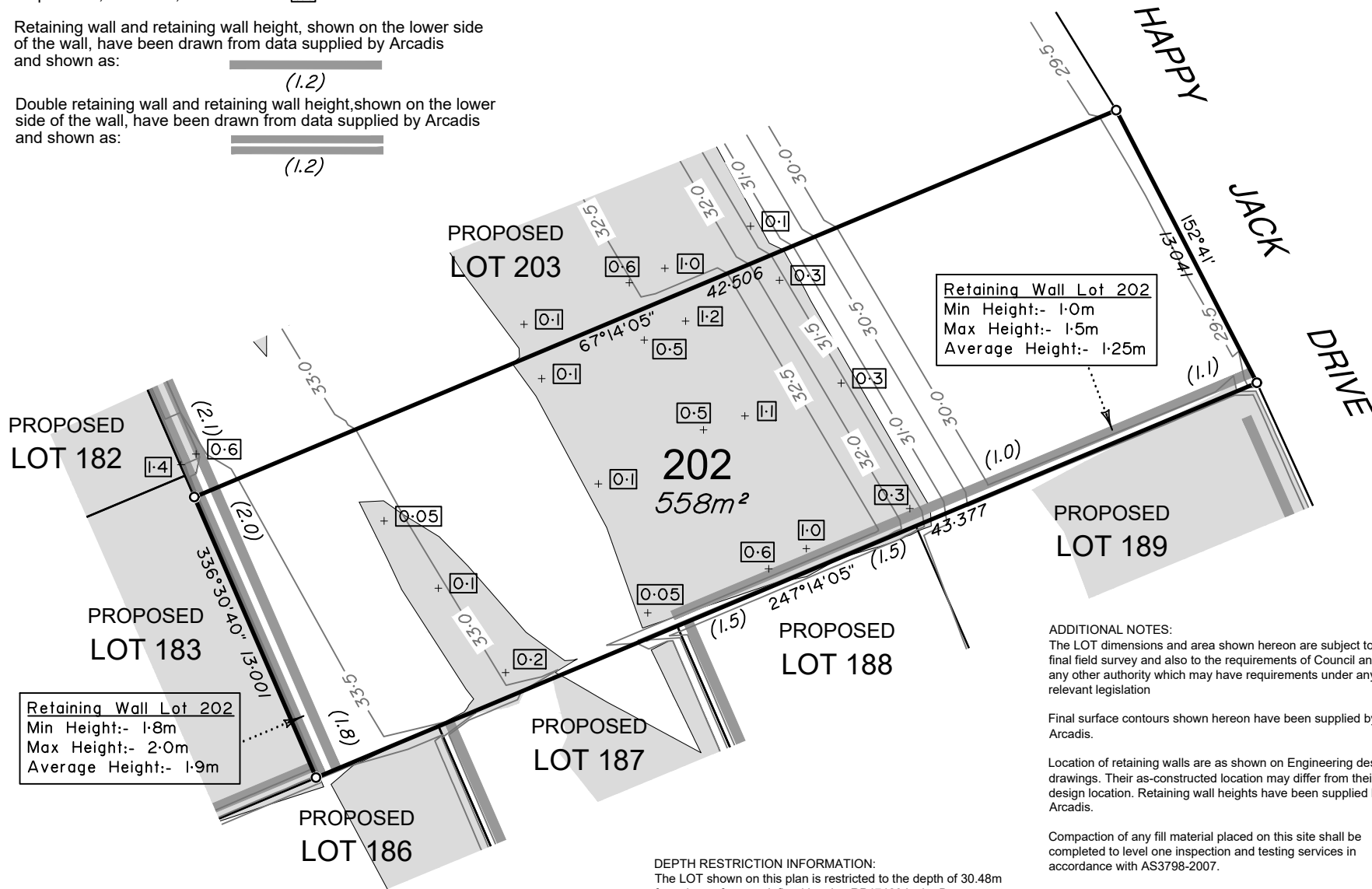

Retaining Wall Lot 202  
Min Height:- 1.0m  
Max Height:- 1.5m  
Average Height:- 1.25m

Retaining Wall Lot 202  
Min Height:- 1.8m  
Max Height:- 2.0m  
Average Height:- 1.9m

**ADDITIONAL NOTES:**  
The LOT dimensions and area shown hereon are subject to final field survey and also to the requirements of Council and any other authority which may have requirements under any relevant legislation

Final surface contours shown hereon have been supplied by Arcadis.

Location of retaining walls are as shown on Engineering design drawings. Their as-constructed location may differ from their design location. Retaining wall heights have been supplied by Arcadis.

Compaction of any fill material placed on this site shall be completed to level one inspection and testing services in accordance with AS3798-2007.

Depth of fill values are calculated to the lower of the pre-development surface and the ground surface from Survey.

Copyright ©Veris Australia Pty Ltd 24/08/2021.

**DEPTH RESTRICTION INFORMATION:**  
The LOT shown on this plan is restricted to the depth of 30.48m from the surface as defined by plan RP47420 in the Department of Resources.



# LEGEND

Final surface contours based on A.H.D. datum at an interval of 0.5m, shown as: -9.5-

Where applicable, areas to be filled are shown as:

Depth of fill, in metres, shown as:- +[1.1]

Retaining wall and retaining wall height, shown on the lower side of the wall, have been drawn from data supplied by Arcadis and shown as: (1.2)

Double retaining wall and retaining wall height, shown on the lower side of the wall, have been drawn from data supplied by Arcadis and shown as: (1.2)

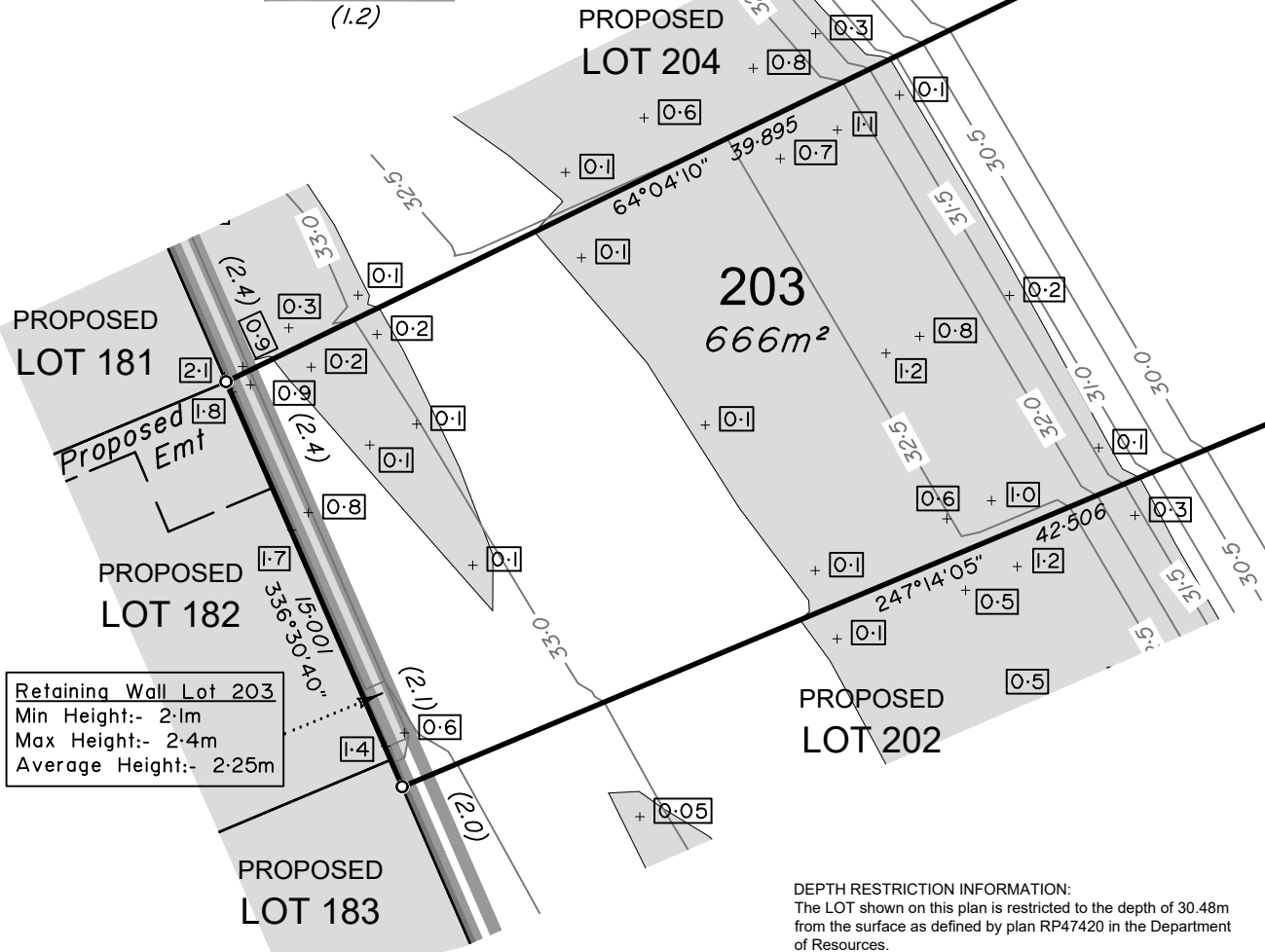

Retaining Wall Lot 203  
Min Height:- 2.1m  
Max Height:- 2.4m  
Average Height:- 2.25m

**DEPTH RESTRICTION INFORMATION:**  
The LOT shown on this plan is restricted to the depth of 30.48m from the surface as defined by plan RP47420 in the Department of Resources.

**ADDITIONAL NOTES:**  
The LOT dimensions and area shown hereon are subject to final field survey and also to the requirements of Council and any other authority which may have requirements under any relevant legislation

Final surface contours shown hereon have been supplied by Arcadis.

Location of retaining walls are as shown on Engineering design drawings. Their as-constructed location may differ from their design location. Retaining wall heights have been supplied by Arcadis.

Compaction of any fill material placed on this site shall be completed to level one inspection and testing services in accordance with AS3798-2007.

Depth of fill values are calculated to the lower of the pre-development surface and the ground surface from Survey.

Copyright ©Veris Australia Pty Ltd 24/08/2021.



## BRENTWOOD STAGE 13

For  
AVID Property Group

**IMPORTANT NOTES:**  
(These notes are an integral part of this plan)  
This plan has been prepared for AVID Property Group for the purposes of a Disclosure Plan Under the Land Sales Act 1984 (as amended).  
It is not to be used by any other person or corporation or for any other purposes and is subject to the following limitations:

Please refer to the approved Development Application for conditions relating to the LOT and to approved Operational Works drawings for services location and possible easements.

THESE DESIGNS AND DRAWINGS ARE COPYRIGHT AND ARE NOT TO BE USED OR REPRODUCED WITHOUT THE WRITTEN PERMISSION OF VERIS

**Data Sources**

Cadastral Boundaries: 400891-001-LC01 Master (L).dwg  
Engineering Design: xc-09-cpw-aa006817-de-DesignBase.dwg  
Final Surface Contours: Brentwood overall design tin.dwg  
Pre-development Surface: 400891-813 DS01(A).dwg  
Retaining Walls: 400891-813 DS01(A).dwg  
xc-09-cpw-aa006817-de-DesignBase for disclosures.dwg

Issue	Revisions	Date	Drawn
A	Original	24/08/2021	GJF

Locality:	Belbird Park
Local Authority:	Ipswich C. C.
Horizontal Meridian:	MGA Zone 56
Vertical Level Datum:	AHD D
Scale:	1:250 @ A4
Designed:	Veris
Drawn:	GJF 24/08/2021
Checked:	KJJ 27/08/2021
Plot Date:	27 Aug, 2021
Comp File Ref:	400891-St13-DP(A).dwg

### DISCLOSURE PLAN of Proposed LOT 203 currently being part of Lot 512 on SP290298 (At time of Settlement being part of Lot 512 on SP330346)



BRISBANE (07) 3666 4700	WHITSUNDAYS (07) 4945 6600
MACKAY (07) 4957 9700	CAIRNS (07) 4252 9400
veris.com.au	
ACN 615 735 727 Veris Australia Pty Ltd	

Drawing No	Issue
400891-DP203	A



# LEGEND

Final surface contours based on A.H.D. datum at an interval of 0.5m, shown as: -9.5-

Where applicable, areas to be filled are shown as:

Depth of fill, in metres, shown as:- +

Retaining wall and retaining wall height, shown on the lower side of the wall, have been drawn from data supplied by Arcadis and shown as: (1.2)

Double retaining wall and retaining wall height, shown on the lower side of the wall, have been drawn from data supplied by Arcadis and shown as: (1.2)

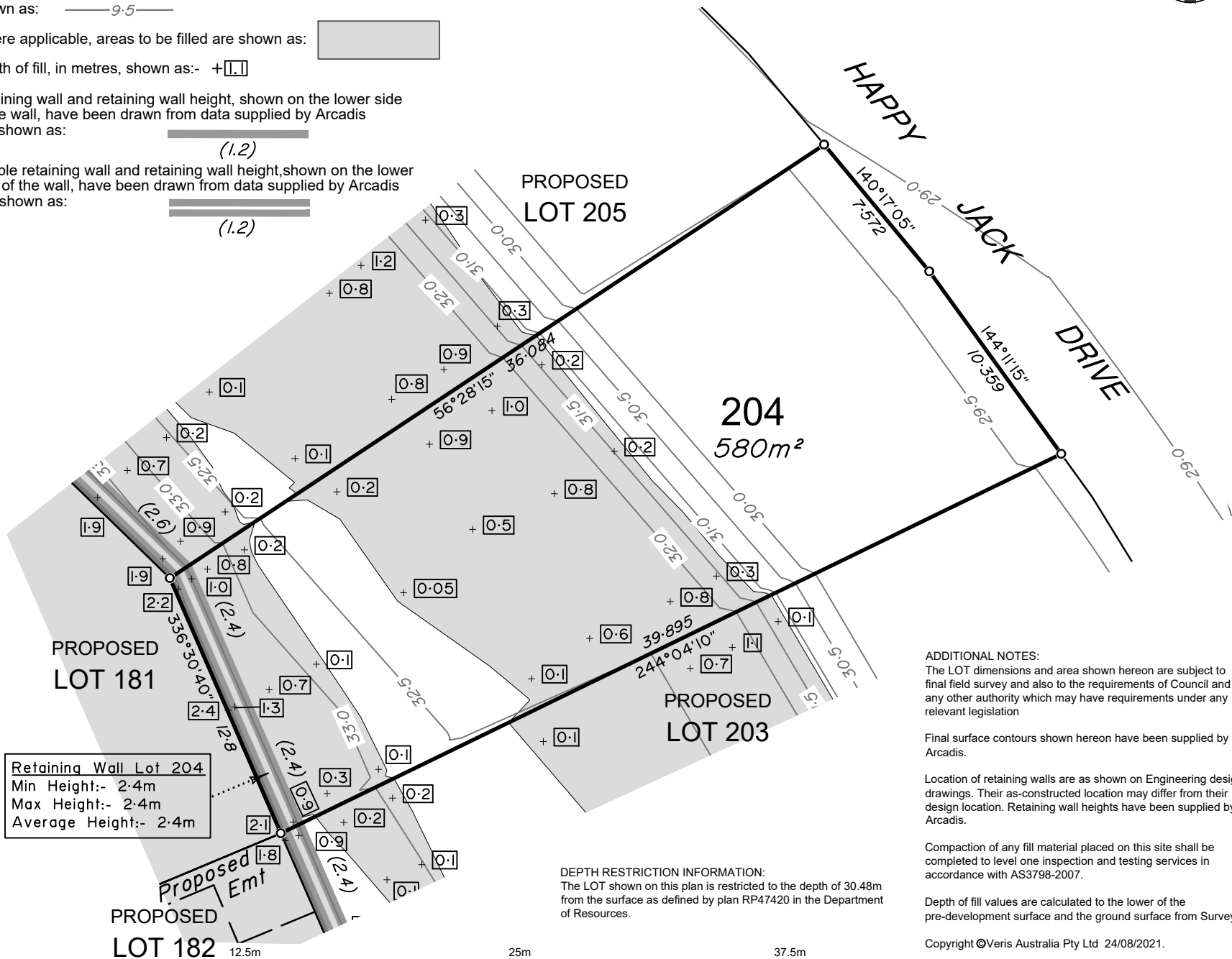

**Retaining Wall Lot 204**  
 Min Height:- 2.4m  
 Max Height:- 2.4m  
 Average Height:- 2.4m

**DEPTH RESTRICTION INFORMATION:**  
 The LOT shown on this plan is restricted to the depth of 30.48m from the surface as defined by plan RP47420 in the Department of Resources.

**ADDITIONAL NOTES:**  
 The LOT dimensions and area shown hereon are subject to final field survey and also to the requirements of Council and any other authority which may have requirements under any relevant legislation

Final surface contours shown hereon have been supplied by Arcadis.

Location of retaining walls are as shown on Engineering design drawings. Their as-constructed location may differ from their design location. Retaining wall heights have been supplied by Arcadis.

Compaction of any fill material placed on this site shall be completed to level one inspection and testing services in accordance with AS3798-2007.

Depth of fill values are calculated to the lower of the pre-development surface and the ground surface from Survey.

Copyright ©Veris Australia Pty Ltd 24/08/2021.



## BRENTWOOD STAGE 13

For  
**AVID Property Group**

**IMPORTANT NOTES:**  
 (These notes are an integral part of this plan)  
 This plan has been prepared for AVID Property Group for the purposes of A Disclosure Plan Under the Land Sales Act 1984 (as amended).  
 It is not to be used by any other person or corporation or for any other purposes and is subject to the following limitations:

Please refer to the approved Development Application for conditions relating to the LOT and to approved Operational Works drawings for services location and possible easements.

THESE DESIGNS AND DRAWINGS ARE COPYRIGHT AND ARE NOT TO BE USED OR REPRODUCED WITHOUT THE WRITTEN PERMISSION OF VERIS

**Data Sources**

Cadastral Boundaries: 400891-001-LC01 Master (L).dwg  
 Engineering Design: xc-09-cpw-aa006817-de-DesignBase.dwg  
 Final Surface Contours: Brentwood overall design tin.dwg  
 Pre-development Surface: 400891-813 DS01(A).dwg  
 Retaining Walls: xc-09-cpw-aa006817-de-DesignBase for disclosures.dwg

Issue	Revisions	Date	Drawn
A	Original	24/08/2021	GJF

Locality: Bellbird Park  
 Local Authority: Ipswich C. C.  
 Horizontal Meridian: MGA Zone 56  
 Vertical Level Datum: AHD D  
 Scale: 1:250 @ A4  
 Designed: Veris  
 Drawn: GJF 24/08/2021  
 Checked: KJJ 27/08/2021  
 Plot Date: 27 Aug, 2021  
 Comp File Ref: 400891-St13-DP(A).dwg

### DISCLOSURE PLAN of Proposed LOT 204

currently being part of Lot 512 on SP290298  
 ( At time of Settlement being part of Lot 512 on SP330346)



BRISBANE (07) 3666 4700	WHITSUNDAYS (07) 4945 6600
MACKAY (07) 4257 9700	CAIRNS (07) 4252 9400
veris.com.au	
ACN 615 735 727 Veris Australia Pty Ltd	

Drawing No  
**400891-DP204**

Issue  
**A**

# LEGEND

Final surface contours based on A.H.D. datum at an interval of 0.5m, shown as: -9.5-

Where applicable, areas to be filled are shown as:

Depth of fill, in metres, shown as:- +

Retaining wall and retaining wall height, shown on the lower side of the wall, have been drawn from data supplied by Arcadis and shown as: (1.2)

Double retaining wall and retaining wall height, shown on the lower side of the wall, have been drawn from data supplied by Arcadis and shown as: (1.2)



## BRENTWOOD STAGE 13

For  
AVID Property Group

**IMPORTANT NOTES:**  
(These notes are an integral part of this plan)  
This plan has been prepared for AVID Property Group for the purposes of A Disclosure Plan Under the Land Sales Act 1984 (as amended).  
It is not to be used by any other person or corporation or for any other purposes and is subject to the following limitations:

Please refer to the approved Development Application for conditions relating to the LOT and to approved Operational Works drawings for services location and possible easements.

THESE DESIGNS AND DRAWINGS ARE COPYRIGHT AND ARE NOT TO BE USED OR REPRODUCED WITHOUT THE WRITTEN PERMISSION OF VERIS

**Data Sources**  
Cadastral Boundaries: 400891-001-LC01 Master (L).dwg  
Engineering Design: xc-09c-opw-aa006817-de-DesignBase.dwg  
Final Surface Contours: Brentwood overall design tin.dwg  
Pre-development Surface: 400891-813 DS01(A).dwg  
Retaining Walls: xc-09c-opw-aa006817-de-DesignBase for disclosures.dwg

Issue	Revisions	Date	Drawn
A	Original	24/08/2021	GJF

Locality: Bellbird Park  
Local Authority: Ipswich C. C.  
Horizontal Meridian: MGA Zone 56  
Vertical Level Datum: AHD D  
Scale: 1:250 @ A4  
Designed: Veris  
Drawn: GJF 24/08/2021  
Checked: KJJ 27/08/2021  
Plot Date: 27 Aug, 2021  
Comp File Ref: 400891-St13-DP(A).dwg

**DISCLOSURE PLAN**  
of Proposed Lot 205  
currently being part of  
Lot 512 on SP290298  
( At time of Settlement being part of Lot 512 on SP330346)



BRISBANE (07) 3666 4700 WHITSUNDAYS (07) 4945 6600  
MACKAY (07) 4257 9700 CAIRNS (07) 4252 9400  
veris.com.au  
ACN 615 735 727  
Veris Australia Pty Ltd

Drawing No 400891-DP205 Issue A

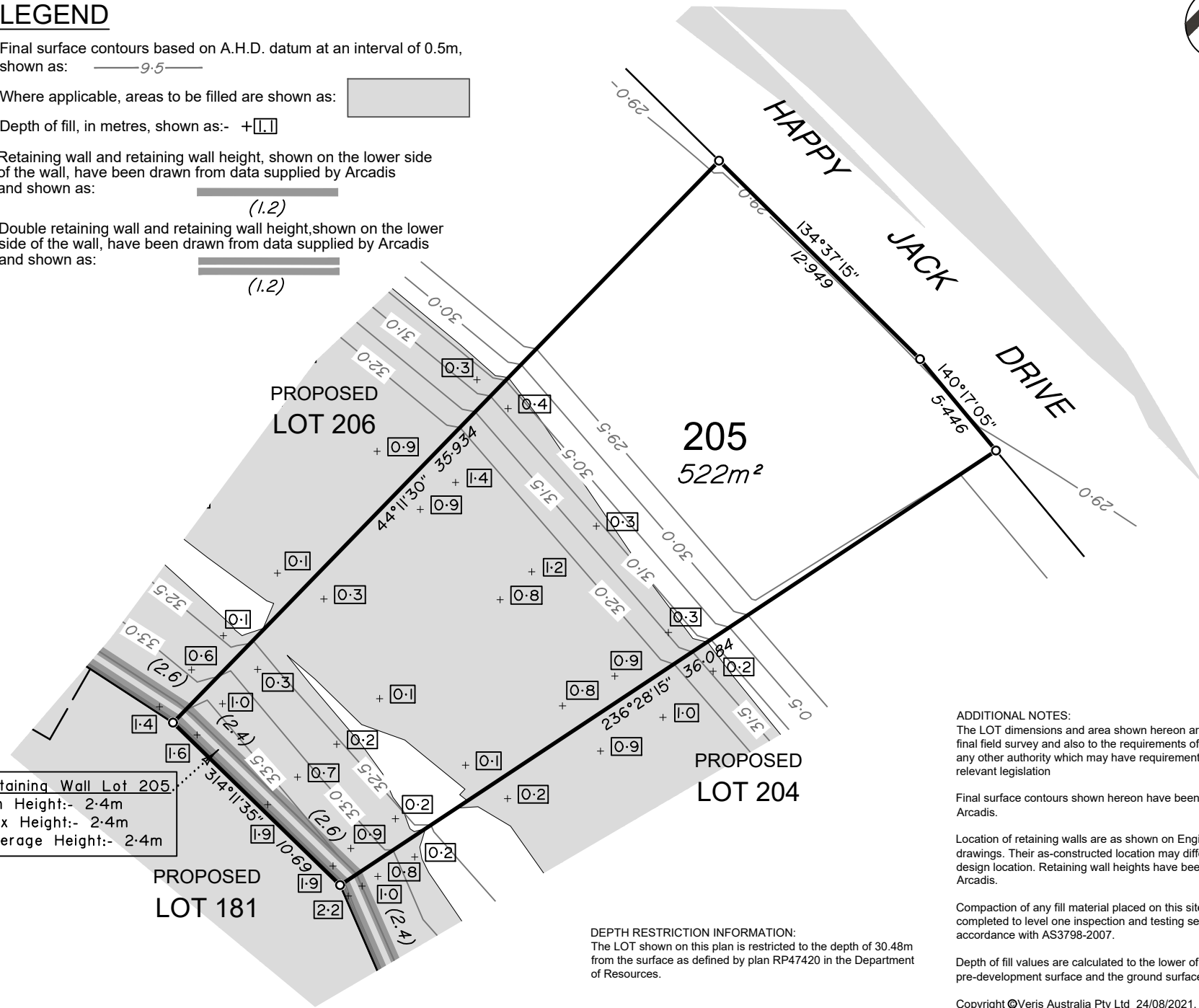

Retaining Wall Lot 205.  
Min Height:- 2.4m  
Max Height:- 2.4m  
Average Height:- 2.4m

**ADDITIONAL NOTES:**  
The LOT dimensions and area shown hereon are subject to final field survey and also to the requirements of Council and any other authority which may have requirements under any relevant legislation

Final surface contours shown hereon have been supplied by Arcadis.

Location of retaining walls are as shown on Engineering design drawings. Their as-constructed location may differ from their design location. Retaining wall heights have been supplied by Arcadis.

Compaction of any fill material placed on this site shall be completed to level one inspection and testing services in accordance with AS3798-2007.

Depth of fill values are calculated to the lower of the pre-development surface and the ground surface from Survey.

Copyright ©Veris Australia Pty Ltd 24/08/2021.

**DEPTH RESTRICTION INFORMATION:**  
The LOT shown on this plan is restricted to the depth of 30.48m from the surface as defined by plan RP47420 in the Department of Resources.



# LEGEND

Final surface contours based on A.H.D. datum at an interval of 0.5m, shown as: -9.5-

Where applicable, areas to be filled are shown as:

Depth of fill, in metres, shown as:- +

Retaining wall and retaining wall height, shown on the lower side of the wall, have been drawn from data supplied by Arcadis and shown as: (1.2)

Double retaining wall and retaining wall height, shown on the lower side of the wall, have been drawn from data supplied by Arcadis and shown as: (1.2)



## BRENTWOOD STAGE 13

For  
AVID Property Group

**IMPORTANT NOTES:**  
(These notes are an integral part of this plan)  
This plan has been prepared for AVID Property Group for the purposes of A Disclosure Plan Under the Land Sales Act 1984 (as amended).  
It is not to be used by any other person or corporation or for any other purposes and is subject to the following limitations:

Please refer to the approved Development Application for conditions relating to the LOT and to approved Operational Works drawings for services location and possible easements.

THESE DESIGNS AND DRAWINGS ARE COPYRIGHT AND ARE NOT TO BE USED OR REPRODUCED WITHOUT THE WRITTEN PERMISSION OF VERIS

**Data Sources**  
Cadastral Boundaries: 400891-001-LC01 Master (L).dwg  
Engineering Design: xc-09c-opw-aa006817-de-DesignBase.dwg  
Final Surface Contours: Brentwood overall design tin.dwg  
Pre-development Surface: 400891-813 DS01(A).dwg  
Retaining Walls: xc-09c-opw-aa006817-de-DesignBase for disclosures.dwg

Issue	Revisions	Date	Drawn
A	Original	24/08/2021	GJF

Locality: Bellbird Park  
Local Authority: Ipswich C. C.  
Horizontal Meridian: MGA Zone 56  
Vertical Level Datum: AHD D  
Scale: 1:250 @ A4  
Designed: Veris  
Drawn: GJF 24/08/2021  
Checked: KJJ 27/08/2021  
Plot Date: 27 Aug, 2021  
Comp File Ref: 400891-St13-DP(A).dwg

**DISCLOSURE PLAN**  
of Proposed Lot 206  
currently being part of  
Lot 512 on SP290298  
( At time of Settlement being part of Lot 512 on SP330346)



BRISBANE (07) 3666 4700 WHITSUNDAYS (07) 4945 6600  
MACKAY (07) 4257 9700 CAIRNS (07) 4252 9400

veris.com.au  
ACN 615 735 727  
Veris Australia Pty Ltd

Drawing No 400891-DP206 Issue A

**Retaining Wall Lot 206**  
Min Height:- 2.6m  
Max Height:- 2.6m  
Average Height:- 2.6m

**ADDITIONAL NOTES:**  
The LOT dimensions and area shown hereon are subject to final field survey and also to the requirements of Council and any other authority which may have requirements under any relevant legislation

Final surface contours shown hereon have been supplied by Arcadis.

Location of retaining walls are as shown on Engineering design drawings. Their as-constructed location may differ from their design location. Retaining wall heights have been supplied by Arcadis.

Compaction of any fill material placed on this site shall be completed to level one inspection and testing services in accordance with AS3798-2007.

Depth of fill values are calculated to the lower of the pre-development surface and the ground surface from Survey.

Copyright ©Veris Australia Pty Ltd 24/08/2021.

**DEPTH RESTRICTION INFORMATION:**  
The LOT shown on this plan is restricted to the depth of 30.48m from the surface as defined by plan RP47420 in the Department of Resources.

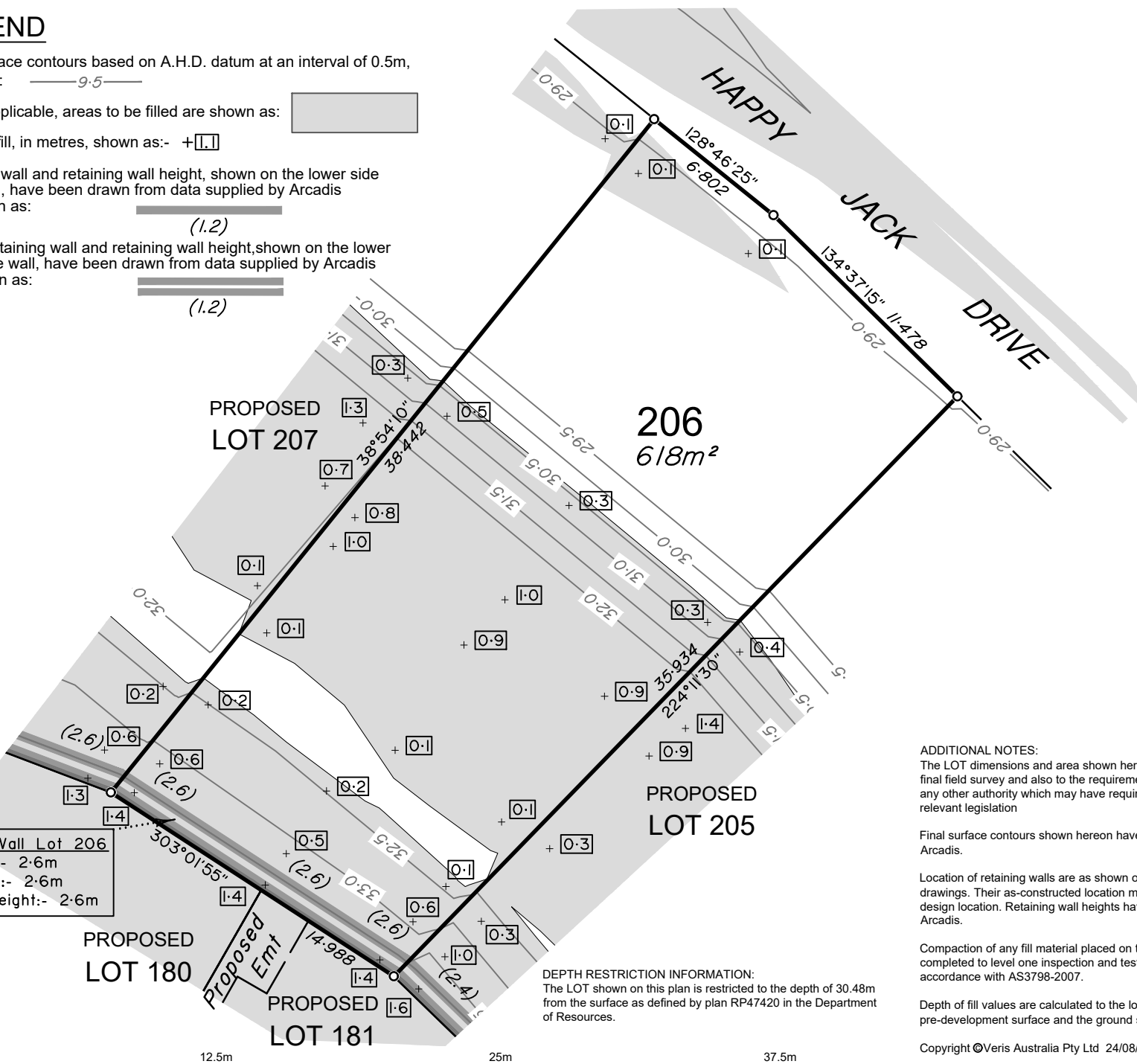



# LEGEND

Final surface contours based on A.H.D. datum at an interval of 0.5m, shown as: 9.5

Where applicable, areas to be filled are shown as:

Depth of fill, in metres, shown as:- +

Retaining wall and retaining wall height, shown on the lower side of the wall, have been drawn from data supplied by Arcadis and shown as: (1.2)

Double retaining wall and retaining wall height, shown on the lower side of the wall, have been drawn from data supplied by Arcadis and shown as: (1.2)

### DEPTH RESTRICTION INFORMATION:

The LOT shown on this plan is restricted to the depth of 30.48m from the surface as defined by plan RP47420 in the Department of Resources.



**BRENTWOOD  
STAGE 13**  
For  
**AVID Property Group**

**IMPORTANT NOTES:**  
(These notes are an integral part of this plan)  
This plan has been prepared for AVID Property Group for the purposes of a Disclosure Plan Under the Land Sales Act 1984 (as amended).  
It is not to be used by any other person or corporation or for any other purposes and is subject to the following limitations:

Please refer to the approved Development Application for conditions relating to the LOT and to approved Operational Works drawings for services location and possible easements.

**THESE DESIGNS AND DRAWINGS ARE COPYRIGHT AND ARE NOT TO BE USED OR REPRODUCED WITHOUT THE WRITTEN PERMISSION OF VERIS**

**Data Sources**  
Cadastral Boundaries: 400891-001-LC01 Master (L).dwg  
Engineering Design: xc-09-cpw-aa006817-de-DesignBase.dwg  
Final Surface Contours: Brentwood overall design tin.dwg  
Pre-development Surface: 400891-813 DS01(A).dwg  
Retaining Walls: xc-09-cpw-aa006817-de-DesignBase for disclosures.dwg

Issue	Revisions	Date	Drawn
A	Original	24/08/2021	GJF

Locality: Bellbird Park  
Local Authority: Ipswich C. C.  
Horizontal Meridian: MGA Zone 56  
Vertical Level Datum: AHD D  
Scale: 1:250 @ A4  
Designed: Veris  
Drawn: GJF 24/08/2021  
Checked: KJJ 27/08/2021  
Plot Date: 27 Aug, 2021  
Comp File Ref: 400891-S13-DP(A).dwg

**DISCLOSURE PLAN**  
of Proposed LOT 207  
currently being part of  
Lot 512 on SP290298  
( At time of Settlement being part of Lot 512 on SP330346)



**BRISBANE** (07) 3666 4700  
**WHITSUNDAYS** (07) 4945 6600  
**MACKAY** (07) 4957 9700  
**CAIRNS** (07) 4252 9400

veris.com.au  
ACN 615 735 727  
Veris Australia Pty Ltd

Drawing No **400891-DP207** Issue **A**

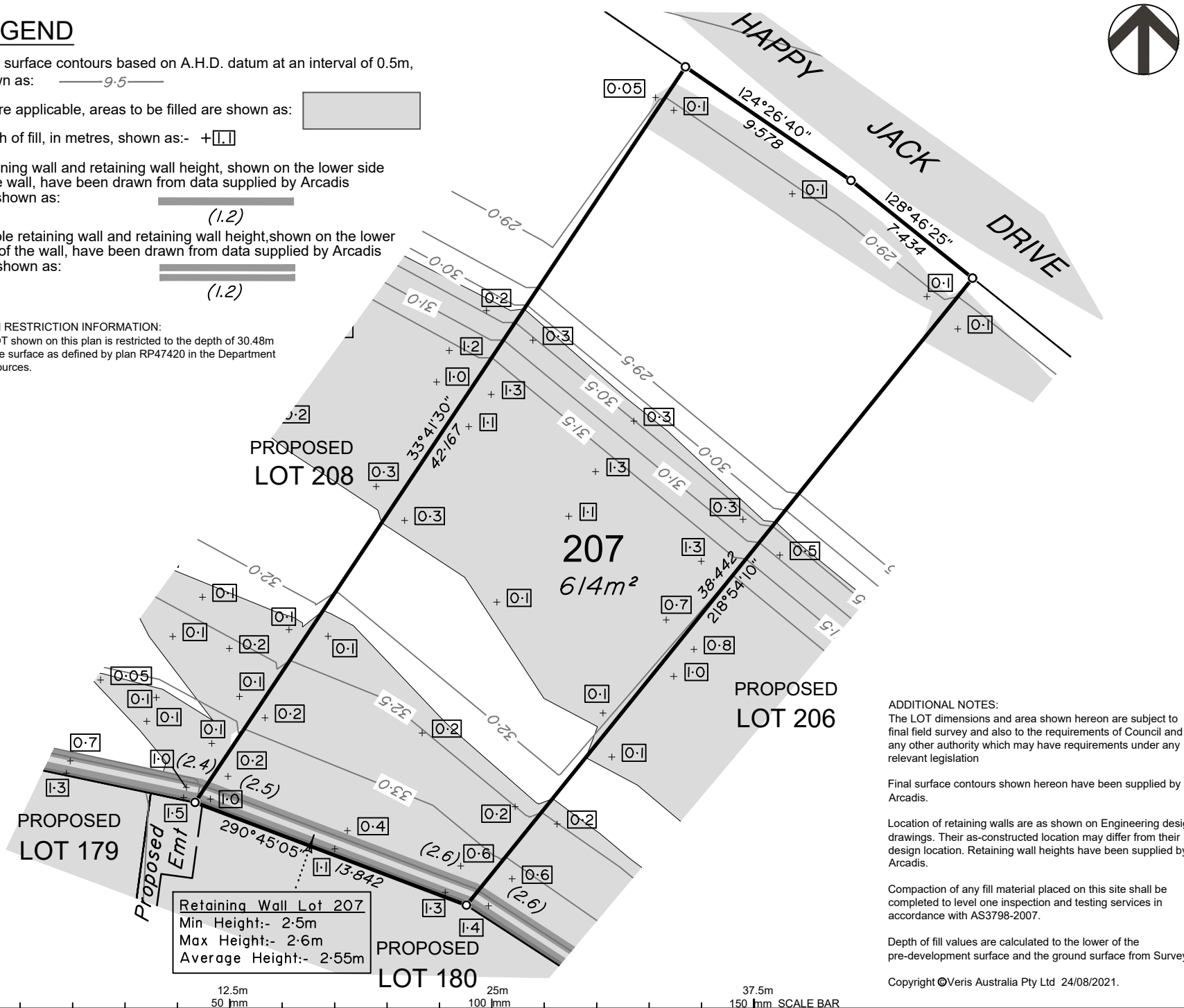

**Retaining Wall Lot 207**  
Min Height:- 2.5m  
Max Height:- 2.6m  
Average Height:- 2.55m

**ADDITIONAL NOTES:**  
The LOT dimensions and area shown hereon are subject to final field survey and also to the requirements of Council and any other authority which may have requirements under any relevant legislation

Final surface contours shown hereon have been supplied by Arcadis.

Location of retaining walls are as shown on Engineering design drawings. Their as-constructed location may differ from their design location. Retaining wall heights have been supplied by Arcadis.

Compaction of any fill material placed on this site shall be completed to level one inspection and testing services in accordance with AS3798-2007.

Depth of fill values are calculated to the lower of the pre-development surface and the ground surface from Survey.

Copyright ©Veris Australia Pty Ltd 24/08/2021.

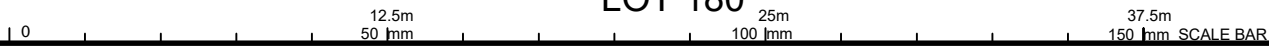

# LEGEND

Final surface contours based on A.H.D. datum at an interval of 0.5m, shown as: -9.5-

Where applicable, areas to be filled are shown as:

Depth of fill, in metres, shown as:- +

Retaining wall and retaining wall height, shown on the lower side of the wall, have been drawn from data supplied by Arcadis and shown as: (1.2)

Double retaining wall and retaining wall height, shown on the lower side of the wall, have been drawn from data supplied by Arcadis and shown as: (1.2)

### DEPTH RESTRICTION INFORMATION:

The LOT shown on this plan is restricted to the depth of 30.48m from the surface as defined by plan RP47420 in the Department of Resources.



**BRENTWOOD  
STAGE 13**  
For  
**AVID Property Group**

**IMPORTANT NOTES:**  
(These notes are an integral part of this plan)  
This plan has been prepared for AVID Property Group for the purposes of a Disclosure Plan Under the Land Sales Act 1984 (as amended).  
It is not to be used by any other person or corporation or for any other purposes and is subject to the following limitations:

Please refer to the approved Development Application for conditions relating to the LOT and to approved Operational Works drawings for services location and possible easements.

THESE DESIGNS AND DRAWINGS ARE COPYRIGHT AND ARE NOT TO BE USED OR REPRODUCED WITHOUT THE WRITTEN PERMISSION OF VERIS

**Data Sources**  
Cadastral Boundaries: 400891-001-LC01 Master (L).dwg  
Engineering Design: xc-09c-opw-aa006817-de-DesignBase.dwg  
Final Surface Contours: Brentwood overall design tin.dwg  
Pre-development Surface: 400891-813 DS01(A).dwg  
Retaining Walls: 400891-813 DS01(A).dwg  
xc-09c-opw-aa006817-de-DesignBase for disclosures.dwg

Issue	Revisions	Date	Drawn
A	Original	24/08/2021	GJF

Locality: Bellbird Park  
Local Authority: Ipswich C. C.  
Horizontal Meridian: MGA Zone 56  
Vertical Level Datum: AHD D  
Scale: 1:250 @ A4  
Designed: Veris  
Drawn: GJF 24/08/2021  
Checked: KJJ 27/08/2021  
Plot Date: 27 Aug, 2021  
Comp File Ref: 400891-St13-DP(A).dwg

**DISCLOSURE PLAN**  
of Proposed LOT 208  
currently being part of  
Lot 512 on SP290298  
( At time of Settlement being part of Lot 512 on SP330346)



BRISBANE (07) 3666 4700 WHITSUNDAYS (07) 4945 6600  
MACKAY (07) 4957 9700 CAIRNS (07) 4252 9400  
veris.com.au  
ACN 615 735 727  
Veris Australia Pty Ltd

Drawing No 400891-DP208 Issue A

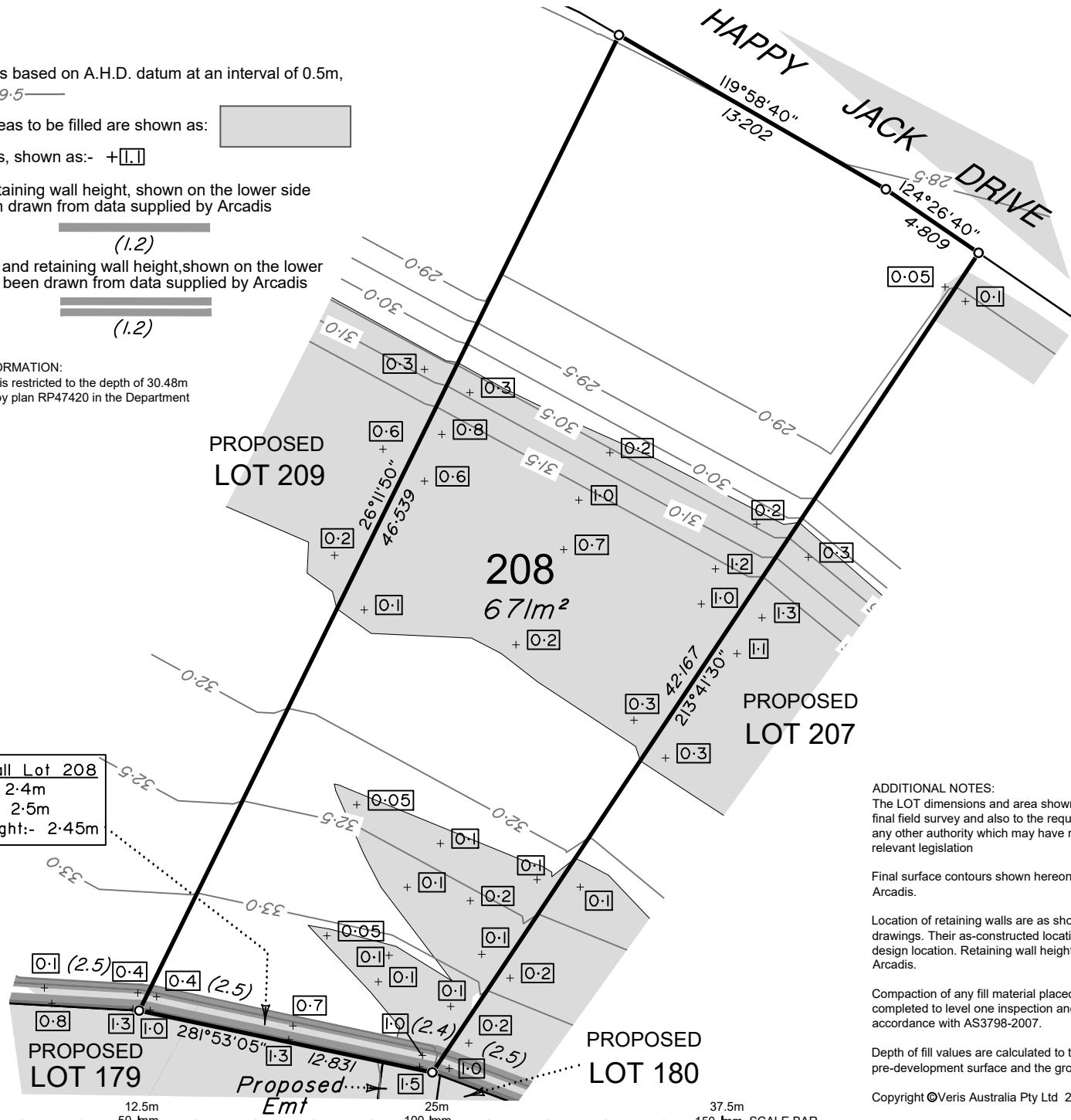

**Retaining Wall Lot 208**  
Min Height:- 2.4m  
Max Height:- 2.5m  
Average Height:- 2.45m

**ADDITIONAL NOTES:**  
The LOT dimensions and area shown hereon are subject to final field survey and also to the requirements of Council and any other authority which may have requirements under any relevant legislation

Final surface contours shown hereon have been supplied by Arcadis.

Location of retaining walls are as shown on Engineering design drawings. Their as-constructed location may differ from their design location. Retaining wall heights have been supplied by Arcadis.

Compaction of any fill material placed on this site shall be completed to level one inspection and testing services in accordance with AS3798-2007.

Depth of fill values are calculated to the lower of the pre-development surface and the ground surface from Survey.

Copyright ©Veris Australia Pty Ltd 24/08/2021.



# LEGEND

Final surface contours based on A.H.D. datum at an interval of 0.5m, shown as: -9.5-

Where applicable, areas to be filled are shown as:

Depth of fill, in metres, shown as: +

Retaining wall and retaining wall height, shown on the lower side of the wall, have been drawn from data supplied by Arcadis and shown as:

Double retaining wall and retaining wall height, shown on the lower side of the wall, have been drawn from data supplied by Arcadis and shown as:

### DEPTH RESTRICTION INFORMATION:

The LOT shown on this plan is restricted to the depth of 30.48m from the surface as defined by plan RP47420 in the Department of Resources.

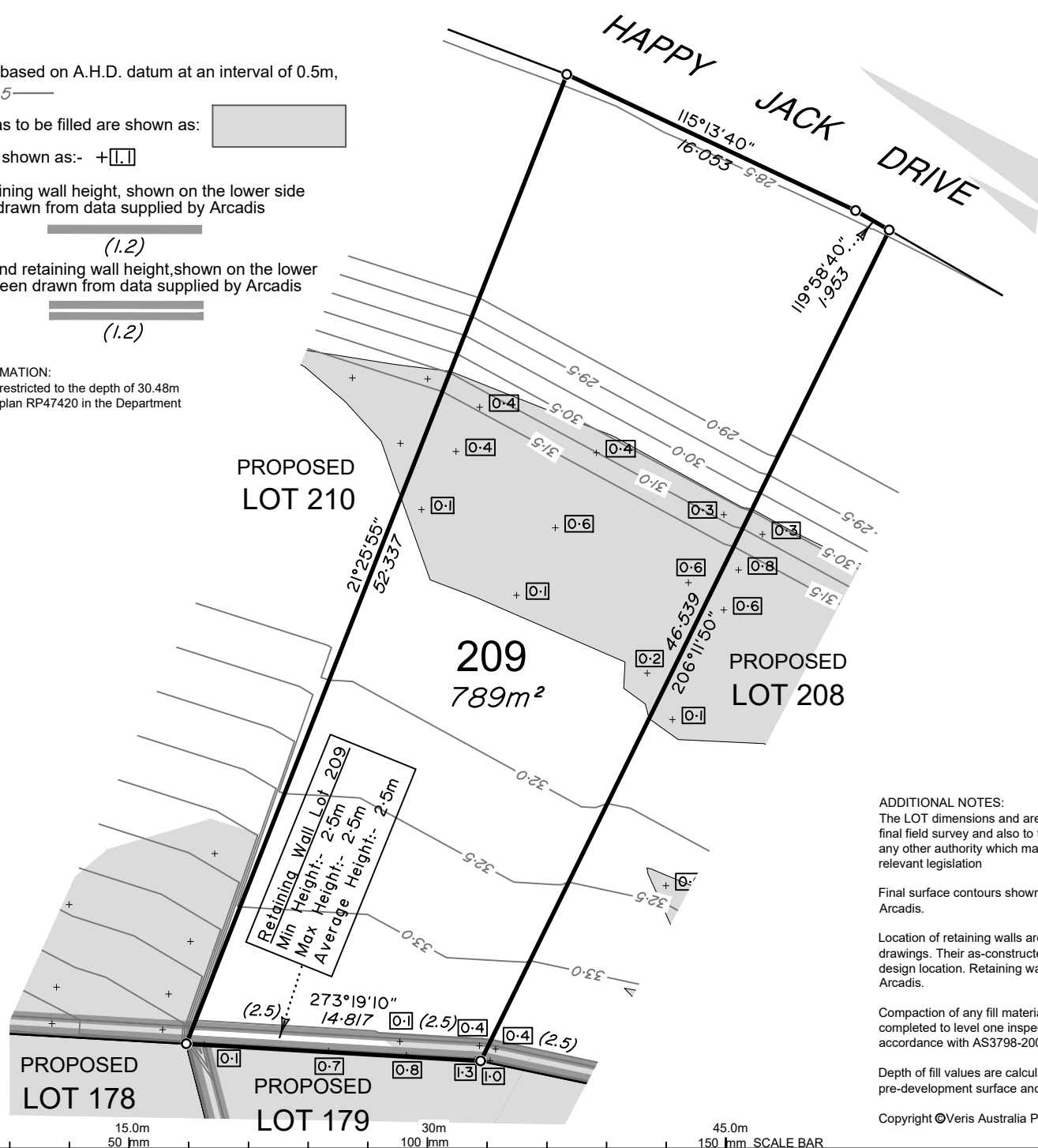

**BRENTWOOD  
STAGE 13**  
For  
**AVID Property Group**

**IMPORTANT NOTES:**  
(These notes are an integral part of this plan)  
This plan has been prepared for AVID Property Group for the purposes of a Disclosure Plan Under the Land Sales Act 1984 (as amended).  
It is not to be used by any other person or corporation or for any other purposes and is subject to the following limitations:

Please refer to the approved Development Application for conditions relating to the LOT and to approved Operational Works drawings for services location and possible easements.

THESE DESIGNS AND DRAWINGS ARE COPYRIGHT AND ARE NOT TO BE USED OR REPRODUCED WITHOUT THE WRITTEN PERMISSION OF VERIS

**Data Sources**  
Cadastral Boundaries: 400891-001-LC01 Master (L).dwg  
Engineering Design: xc-09c-opw-aa006817-de-DesignBase.dwg  
Final Surface Contours: Brentwood overall design tin.dwg  
Pre-development Surface: 400891-813 DS01(A).dwg  
Retaining Walls: 400891-813 DS01(A).dwg  
xc-09c-opw-aa006817-de-DesignBase for disclosures.dwg

Issue	Revisions	Date	Drawn
A	Original	24/08/2021	GJF

Locality: Bellbird Park  
Local Authority: Ipswich C. C.  
Horizontal Meridian: MGA Zone 56  
Vertical Level Datum: AHD D  
Scale: 1:300 @ A4  
Designed: Veris  
Drawn: GJF 24/08/2021  
Checked: KJJ 27/08/2021  
Plot Date: 27 Aug, 2021  
Comp File Ref: 400891-St13-DP(A).dwg

**DISCLOSURE PLAN**  
of Proposed LOT 209  
currently being part of  
Lot 512 on SP290298  
( At time of Settlement being part of Lot 512 on SP330346)



BRISBANE (07) 3666 4700 WHITSUNDAYS (07) 4945 6600  
MACKAY (07) 4957 9700 CAIRNS (07) 4252 9400  
veris.com.au  
ACN 615 735 727  
Veris Australia Pty Ltd

Drawing No 400891-DP209 Issue A

**ADDITIONAL NOTES:**  
The LOT dimensions and area shown hereon are subject to final field survey and also to the requirements of Council and any other authority which may have requirements under any relevant legislation

Final surface contours shown hereon have been supplied by Arcadis.

Location of retaining walls are as shown on Engineering design drawings. Their as-constructed location may differ from their design location. Retaining wall heights have been supplied by Arcadis.

Compaction of any fill material placed on this site shall be completed to level one inspection and testing services in accordance with AS3798-2007.

Depth of fill values are calculated to the lower of the pre-development surface and the ground surface from Survey.

Copyright ©Veris Australia Pty Ltd 24/08/2021.



# LEGEND

Final surface contours based on A.H.D. datum at an interval of 0.5m, shown as: -9.5-

Where applicable, areas to be filled are shown as:

Depth of fill, in metres, shown as:- +

Retaining wall and retaining wall height, shown on the lower side of the wall, have been drawn from data supplied by Arcadis and shown as: (1.2)

Double retaining wall and retaining wall height, shown on the lower side of the wall, have been drawn from data supplied by Arcadis and shown as: (1.2)

### DEPTH RESTRICTION INFORMATION:

The LOT shown on this plan is restricted to the depth of 30.48m from the surface as defined by plan RP47420 in the Department of Resources.

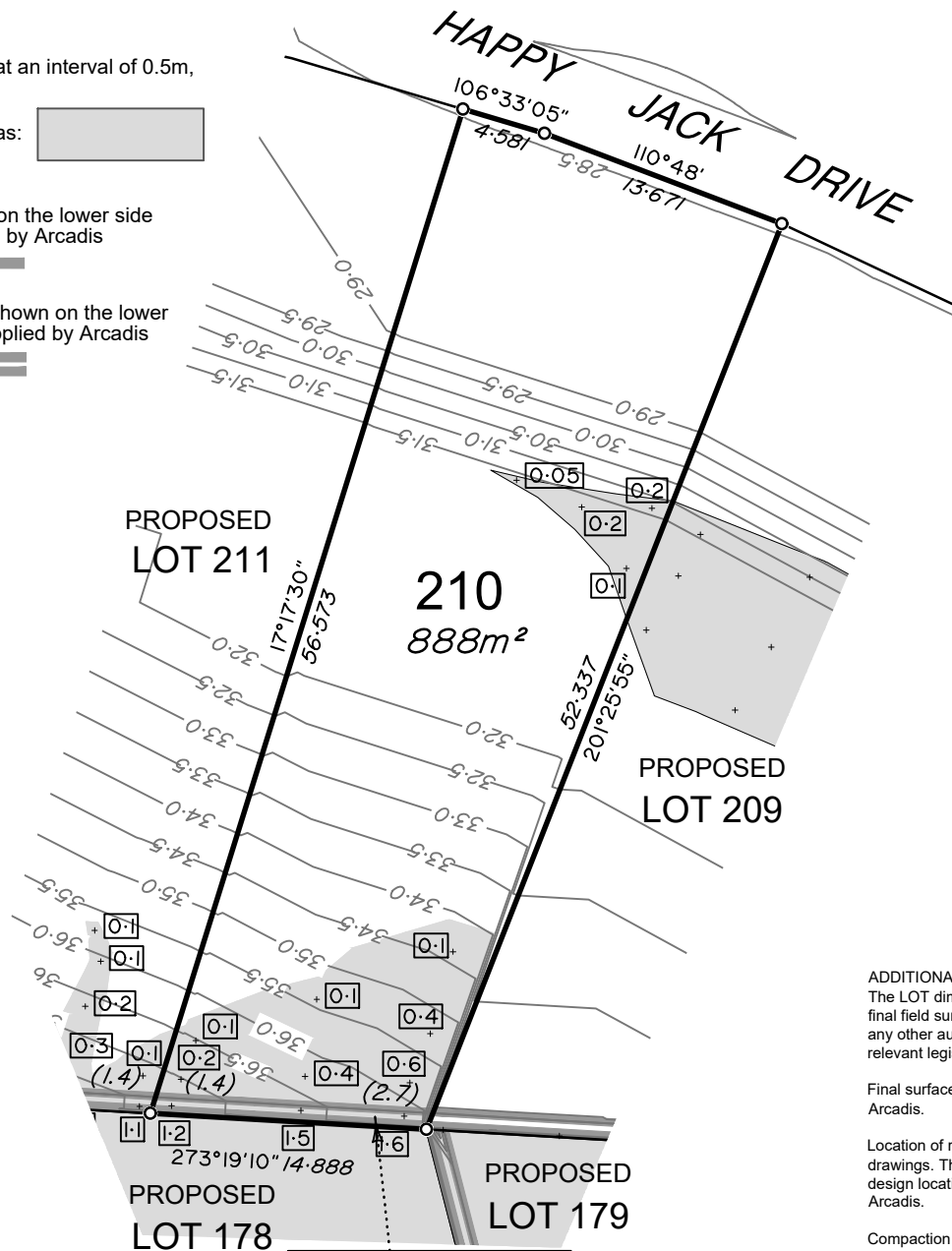

**Retaining Wall Lot 210**  
 Min Height:- 1.4m  
 Max Height:- 2.7m  
 Average Height:- 2.05m



## BRENTWOOD STAGE 13

For  
**AVID Property Group**

**IMPORTANT NOTES:**  
 (These notes are an integral part of this plan)  
 This plan has been prepared for AVID Property Group for the purposes of a Disclosure Plan Under the Land Sales Act 1984 (as amended).  
 It is not to be used by any other person or corporation or for any other purposes and is subject to the following limitations:

Please refer to the approved Development Application for conditions relating to the LOT and to approved Operational Works drawings for services location and possible easements.

THESE DESIGNS AND DRAWINGS ARE COPYRIGHT AND ARE NOT TO BE USED OR REPRODUCED WITHOUT THE WRITTEN PERMISSION OF VERIS

**Data Sources**  
 Cadastral Boundaries: 400891-001-LC01 Master (L).dwg  
 Engineering Design: xc-09c-opw-aa006817-de-DesignBase.dwg  
 Final Surface Contours: Brentwood overall design tin.dwg  
 Pre-development Surface: 400891-813 DS01(A).dwg  
 Retaining Walls: 400891-813 DS01(A).dwg  
 xc-09c-opw-aa006817-de-DesignBase for disclosures.dwg

Issue	Revisions	Date	Drawn
A	Original	24/08/2021	GJF

Locality: Bellbird Park  
 Local Authority: Ipswich C. C.  
 Horizontal Meridian: MGA Zone 56  
 Vertical Level Datum: AHD D  
 Scale: 1:400 @ A4  
 Designed: Veris  
 Drawn: GJF 24/08/2021  
 Checked: KJJ 27/08/2021  
 Plot Date: 27 Aug, 2021  
 Comp File Ref: 400891-S113-DP(A).dwg

### DISCLOSURE PLAN of Proposed LOT 210 currently being part of Lot 512 on SP290298 (At time of Settlement being part of Lot 512 on SP330346)



BRISBANE (07) 3666 4700 WHITSUNDAYS (07) 4945 6600  
 MACKAY (07) 4957 9700 CAIRNS (07) 4252 9400  
 veris.com.au  
 ACN 615 735 727  
 Veris Australia Pty Ltd

Drawing No 400891-DP210 Issue A

**ADDITIONAL NOTES:**  
 The LOT dimensions and area shown hereon are subject to final field survey and also to the requirements of Council and any other authority which may have requirements under any relevant legislation

Final surface contours shown hereon have been supplied by Arcadis.

Location of retaining walls are as shown on Engineering design drawings. Their as-constructed location may differ from their design location. Retaining wall heights have been supplied by Arcadis.

Compaction of any fill material placed on this site shall be completed to level one inspection and testing services in accordance with AS3798-2007.

Depth of fill values are calculated to the lower of the pre-development surface and the ground surface from Survey.

Copyright ©Veris Australia Pty Ltd 24/08/2021.



# LEGEND

Final surface contours based on A.H.D. datum at an interval of 0.5m, shown as: 9.5

Where applicable, areas to be filled are shown as:

Depth of fill, in metres, shown as:- +

Retaining wall and retaining wall height, shown on the lower side of the wall, have been drawn from data supplied by Arcadis and shown as:

(1.2)

Double retaining wall and retaining wall height, shown on the lower side of the wall, have been drawn from data supplied by Arcadis and shown as:

(1.2)

### DEPTH RESTRICTION INFORMATION:

The LOT shown on this plan is restricted to the depth of 30.48m from the surface as defined by plan RP47420 in the Department of Resources.



## BRENTWOOD STAGE 13

For  
AVID Property Group

**IMPORTANT NOTES:**  
(These notes are an integral part of this plan)  
This plan has been prepared for AVID Property Group for the purposes of A Disclosure Plan Under the Land Sales Act 1984 (as amended).  
It is not to be used by any other person or corporation or for any other purposes and is subject to the following limitations:

Please refer to the approved Development Application for conditions relating to the LOT and to approved Operational Works drawings for services location and possible easements.

THESE DESIGNS AND DRAWINGS ARE COPYRIGHT AND ARE NOT TO BE USED OR REPRODUCED WITHOUT THE WRITTEN PERMISSION OF VERIS

**Data Sources**  
Cadastral Boundaries: 400891-001-LC01 Master (L).dwg  
Engineering Design: xc-09-opw-aa006817-de-DesignBase.dwg  
Final Surface Contours: Brentwood overall design tin.dwg  
Pre-development Surface: 400891-813 DS01(A).dwg  
Retaining Walls: 400891-813 DS01(A).dwg  
xc-09-opw-aa006817-de-DesignBase for disclosures.dwg

Issue	Revisions	Date	Drawn
A	Original	24/08/2021	GJF

Locality: Bellbird Park  
Local Authority: Ipswich C. C.  
Horizontal Meridian: MGA Zone 56  
Vertical Level Datum: AHD D  
Scale: 1:400 @ A4  
Designed: Veris  
Drawn: GJF 24/08/2021  
Checked: KJJ 27/08/2021  
Plot Date: 27 Aug, 2021  
Comp File Ref: 400891-St13-DP(A).dwg

### DISCLOSURE PLAN of Proposed LOT 211 currently being part of Lot 512 on SP290298 (At time of Settlement being part of Lot 512 on SP330346)



BRISBANE (07) 3666 4700 WHITSUNDAYS (07) 4945 6600  
MACKAY (07) 4957 9700 CAIRNS (07) 4252 9400

veris.com.au  
ACN 615 735 727  
Veris Australia Pty Ltd

Drawing No Issue  
400891-DP211 A

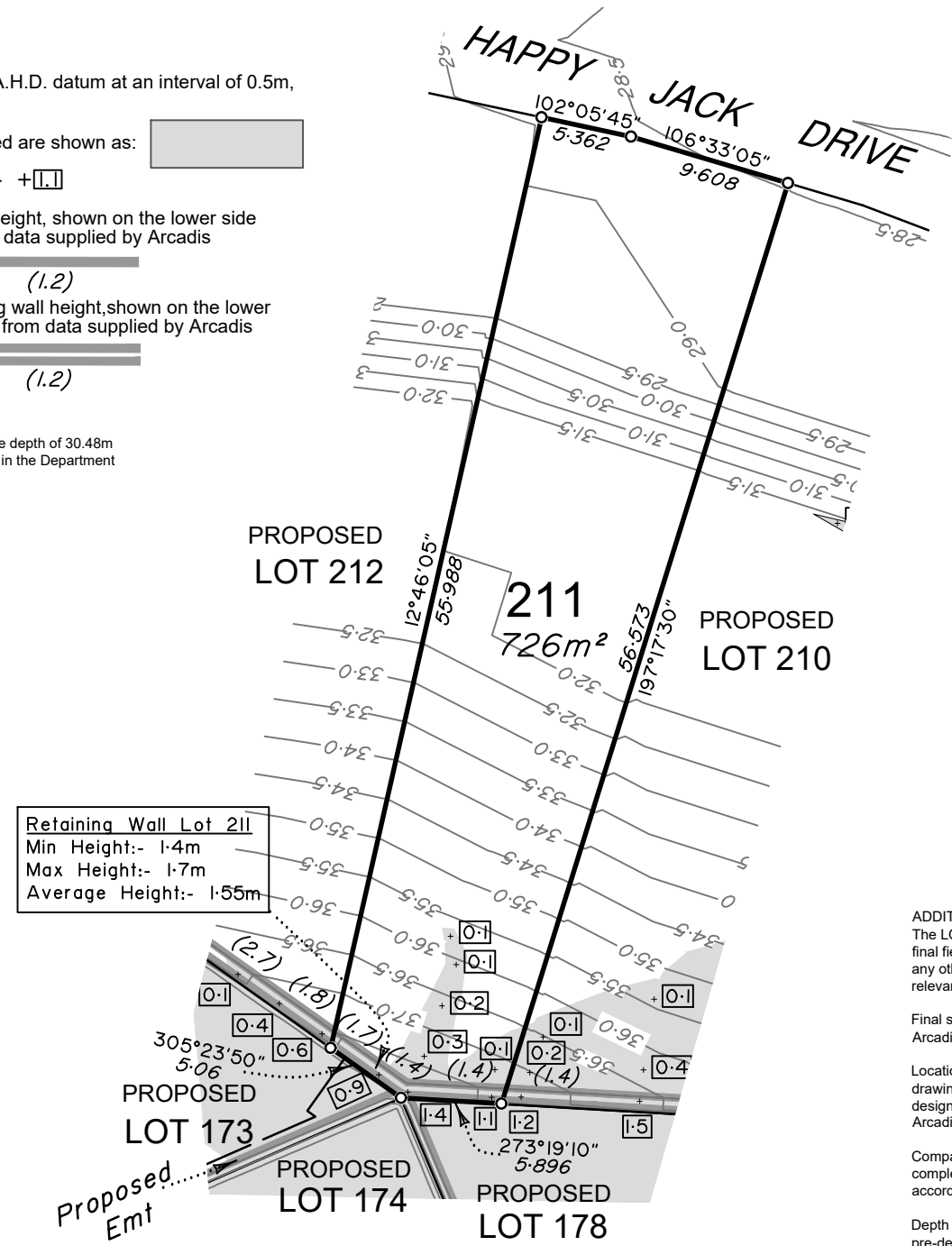

**Retaining Wall Lot 211**  
Min Height:- 1.4m  
Max Height:- 1.7m  
Average Height:- 1.55m

### ADDITIONAL NOTES:

The LOT dimensions and area shown hereon are subject to final field survey and also to the requirements of Council and any other authority which may have requirements under any relevant legislation

Final surface contours shown hereon have been supplied by Arcadis.

Location of retaining walls are as shown on Engineering design drawings. Their as-constructed location may differ from their design location. Retaining wall heights have been supplied by Arcadis.

Compaction of any fill material placed on this site shall be completed to level one inspection and testing services in accordance with AS3798-2007.

Depth of fill values are calculated to the lower of the pre-development surface and the ground surface from Survey.

Copyright ©Veris Australia Pty Ltd 24/08/2021.



# LEGEND

Final surface contours based on A.H.D. datum at an interval of 0.5m, shown as: 9.5

Where applicable, areas to be filled are shown as:

Depth of fill, in metres, shown as:- +

Retaining wall and retaining wall height, shown on the lower side of the wall, have been drawn from data supplied by Arcadis and shown as:

(1.2)

Double retaining wall and retaining wall height, shown on the lower side of the wall, have been drawn from data supplied by Arcadis and shown as:

(1.2)

### DEPTH RESTRICTION INFORMATION:

The LOT shown on this plan is restricted to the depth of 30.48m from the surface as defined by plan RP47420 in the Department of Resources.

Retaining Wall Lot 212  
Min Height:- 0.1m  
Max Height:- 0.8m  
Average Height:- 0.7m

Retaining Wall Lot 212  
Min Height:- 0.8m  
Max Height:- 2.7m  
Average Height:- 1.7m

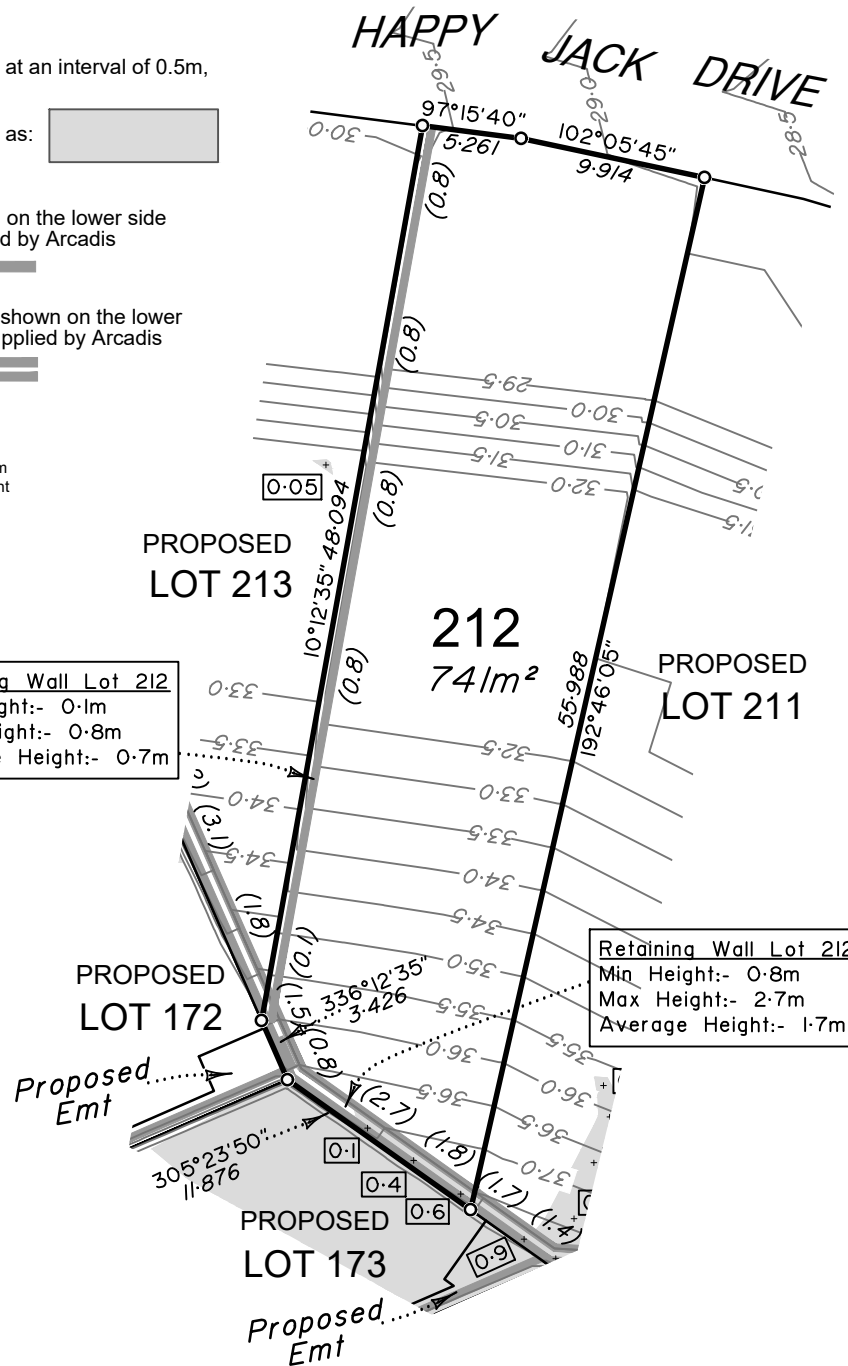

### ADDITIONAL NOTES:

The LOT dimensions and area shown hereon are subject to final field survey and also to the requirements of Council and any other authority which may have requirements under any relevant legislation

Final surface contours shown hereon have been supplied by Arcadis.

Location of retaining walls are as shown on Engineering design drawings. Their as-constructed location may differ from their design location. Retaining wall heights have been supplied by Arcadis.

Compaction of any fill material placed on this site shall be completed to level one inspection and testing services in accordance with AS3798-2007.

Depth of fill values are calculated to the lower of the pre-development surface and the ground surface from Survey.

Copyright ©Veris Australia Pty Ltd 24/08/2021.



## BRENTWOOD STAGE 13

For  
AVID Property Group

### IMPORTANT NOTES:

(These notes are an integral part of this plan)

This plan has been prepared for AVID Property Group for the purposes of a Disclosure Plan Under the Land Sales Act 1984 (as amended).

It is not to be used by any other person or corporation or for any other purposes and is subject to the following limitations:

Please refer to the approved Development Application for conditions relating to the LOT and to approved Operational Works drawings for services location and possible easements.

THESE DESIGNS AND DRAWINGS ARE COPYRIGHT AND ARE NOT TO BE USED OR REPRODUCED WITHOUT THE WRITTEN PERMISSION OF VERIS

### Data Sources

Cadastral Boundaries: 400891-001-LC01 Master (L).dwg  
Engineering Design: xc-09c-opw-aa006817-de-DesignBase.dwg  
Final Surface Contours: Brentwood overall design tin.dwg  
Pre-development Surface: 400891-813 DS01(A).dwg  
Retaining Walls: xc-09c-opw-aa006817-de-DesignBase for disclosures.dwg

Issue	Revisions	Date	Drawn
A	Original	24/08/2021	GJF

Locality: Bellbird Park  
Local Authority: Ipswich C. C.  
Horizontal Meridian: MGA Zone 56  
Vertical Level Datum: AHD D  
Scale: 1:400 @ A4  
Designed: Veris  
Drawn: GJF 24/08/2021  
Checked: KJJ 27/08/2021  
Plot Date: 27 Aug, 2021

Comp File Ref: 400891-St13-DP(A).dwg

## DISCLOSURE PLAN of Proposed LOT 212 currently being part of Lot 512 on SP290298 (At time of Settlement being part of Lot 512 on SP330346)



BRISBANE (07) 3666 4700 WHITSUNDAYS (07) 4945 6600  
MACKAY (07) 4957 9700 CAIRNS (07) 4252 9400

veris.com.au  
ACN 615 735 727  
Veris Australia Pty Ltd

Drawing No 400891-DP212 Issue A



