

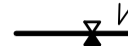









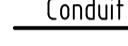
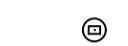

LEGEND

-  NEW HYDRANT
-  NEW SLUICE VALVE
-  NEW TEE
-  NEW END CAP
-  NEW TAPER
-  NEW WATER SERVICE CONDUIT (ø100 PVC-M PN16)
-  NEW WATER METER
-  NEW WATER HOUSE CONNECTION (TAPPING BAND)
-  EXISTING HYDRANT
-  EXISTING SLUICE VALVE
-  EXISTING TEE
-  EXISTING WATER HOUSE CONNECTION (TAPPING BAND)
-  EXISTING WATER MAIN

REGISTERED SURVEYOR'S CERTIFICATION

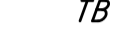
I, Veris Australia Pty Ltd, hereby certify that the vertical and horizontal locations and dimensions shown on this plan are a true and correct record and were located by survey.

Christina Byrom 6448 16/08/2022
 Registered Surveyor (sig.) Reg. Surveyor No. Date

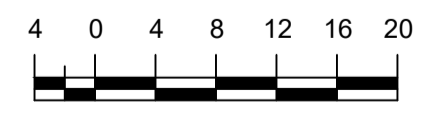
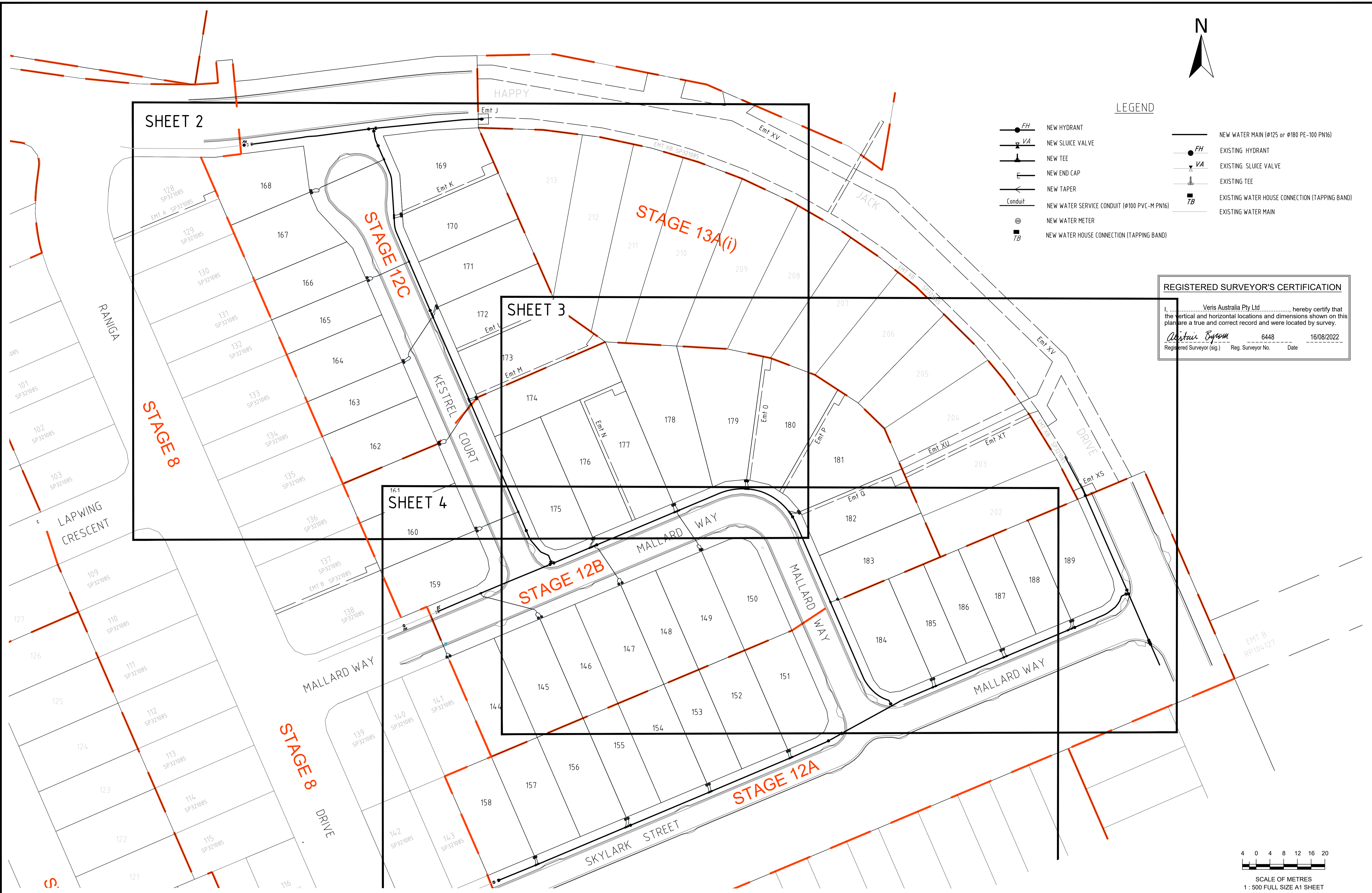

SCALE OF METRES
 1 : 500 FULL SIZE A1 SHEET

A1	C	16/08/2022	PROGRESS PLOT	JMc		DRAWN	GJF	18/03/2022
	B	01/07/2022	PROGRESS PLOT	JMc		CHECKED		
	A	18/03/2022	PROGRESS PLOT	GJF		APPROVED		
	REV NO	DATE	REVISION PURPOSE / DESCRIPTION	DRAWN	RPEQ	RPEQ No	INITIALS	DATE

veris

BRISBANE (07) 3666 4700 WHITSUNDAYS (07) 4945 6600
 MACKAY (07) 4957 9700 CAIRNS (07) 4252 9400

veris.com.au
 ACN 615 736 727
 Veris Australia Pty Ltd

QUEENSLAND UrbanUtilities

BRENTWOOD FOREST
 7000 Jones Road, Bellbird Park
AS CONSTRUCTED WATER STAGE 12
 WATER

DRAWING STATUS	
AS CONSTRUCTED	
SHEET 1 OF 4 SHEETS	
DRAWING NO.	REV.
400891-AW12	C



REGISTERED SURVEYOR'S CERTIFICATION

I, Veris Australia Pty Ltd, hereby certify that the vertical and horizontal locations and dimensions shown on this plan are a true and correct record and were located by survey.

Alistair Byron 6448 16/08/2022
 Registered Surveyor (sig.) Reg. Surveyor No. Date

LEGEND

	NEW HYDRANT		EXISTING HYDRANT
	NEW SLUICE VALVE		EXISTING SLUICE VALVE
	NEW TEE		EXISTING TEE
	NEW END CAP		EXISTING WATER HOUSE CONNECTION (TAPPING BAND)
	NEW TAPER		EXISTING WATER MAIN
	NEW WATER SERVICE CONDUIT (Ø100 PVC-M PN16)		
	NEW WATER METER		
	NEW WATER HOUSE CONNECTION (TAPPING BAND)		
	NEW WATER MAIN (Ø125 or Ø180 PE-100 PN16)		
	EXISTING WATER MAIN		

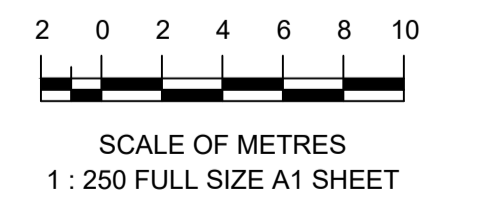

A1	REV NO	DATE	REVISION PURPOSE / DESCRIPTION	DRAWN	RPEQ	RPEQ No	INITIALS	DATE
	C	16/08/2022	PROGRESS PLOT	JMc				18/03/2022
	B	01/07/2022	PROGRESS PLOT	JMc				
	A	18/03/2022	PROGRESS PLOT	GJF				

veris

BRISBANE (07) 3664 4700 WHITSUNDAYS (07) 4945 6600
 MACKAY (07) 4957 9700 CAIRNS (07) 4252 9400
 veris.com.au
 ACN 615 736 727
 Veris Australia Pty Ltd

QUEENSLAND UrbanUtilities

BRENTWOOD FOREST
 7000 Jones Road, Bellbird Park
AS CONSTRUCTED WATER STAGE 12
WATER

DRAWING STATUS	
AS CONSTRUCTED	
SHEET 2 OF 4 SHEETS	
DRAWING NO.	REV.
400891-AW12	C

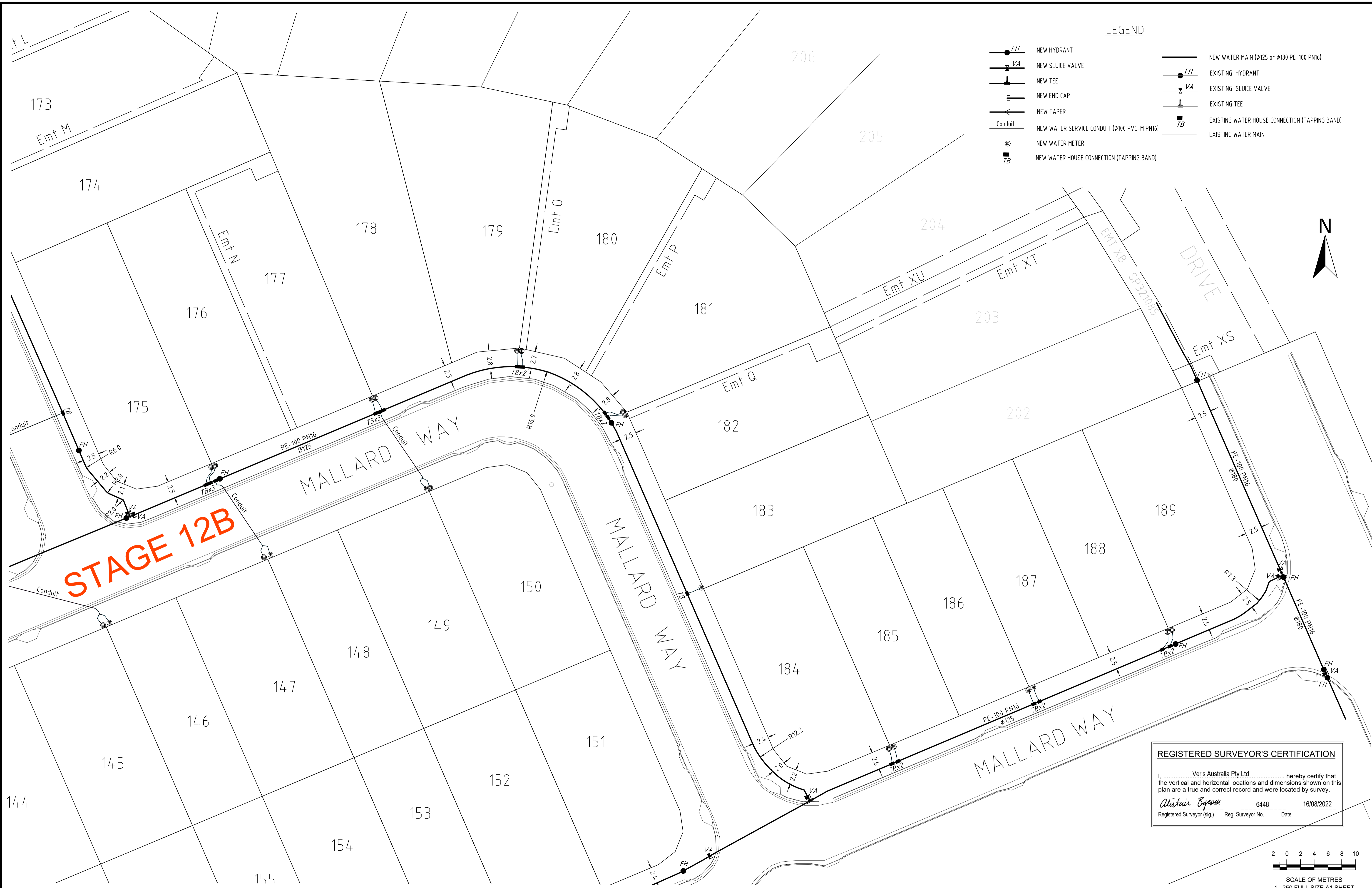

LEGEND

	NEW HYDRANT		EXISTING HYDRANT
	NEW SLUICE VALVE		EXISTING SLUICE VALVE
	NEW TEE		EXISTING TEE
	NEW END CAP		EXISTING WATER HOUSE CONNECTION (TAPPING BAND)
	NEW TAPER		EXISTING WATER MAIN
	NEW WATER SERVICE CONDUIT (Ø100 PVC-M PN16)		
	NEW WATER METER		
	NEW WATER HOUSE CONNECTION (TAPPING BAND)		

STAGE 12B

REGISTERED SURVEYOR'S CERTIFICATION

I, Veris Australia Pty Ltd hereby certify that the vertical and horizontal locations and dimensions shown on this plan are a true and correct record and were located by survey.

Alistair Byrom 6448 16/08/2022
 Registered Surveyor (sig.) Reg. Surveyor No. Date

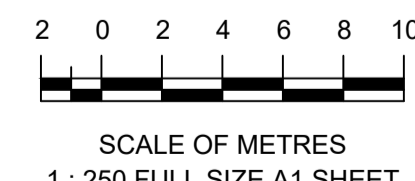

A1	C	16/08/2022	PROGRESS PLOT	JMc			DRAWN	GJF	18/03/2022
	B	01/07/2022	PROGRESS PLOT	JMc			CHECKED		
	A	18/03/2022	PROGRESS PLOT	GJF			APPROVED		
	REV NO	DATE	REVISION PURPOSE / DESCRIPTION	DRAWN	RPEQ	RPEQ No		INITIALS	DATE

veris

BRISBANE (07) 3664 4700 WHITSUNDAYS (07) 4945 6000
 MACKAY (07) 4957 9700 CAIRNS (07) 4252 9400
 veris.com.au
 ACN 615 735 727
 Veris Australia Pty Ltd



BRENTWOOD FOREST
 7000 Jones Road, Bellbird Park
AS CONSTRUCTED WATER STAGE 12
WATER

DRAWING STATUS
AS CONSTRUCTED
 SHEET 3 OF 4 SHEETS
 DRAWING NO. **400891-AW12** REV. **C**

101



STAGE 12B

STAGE 12A

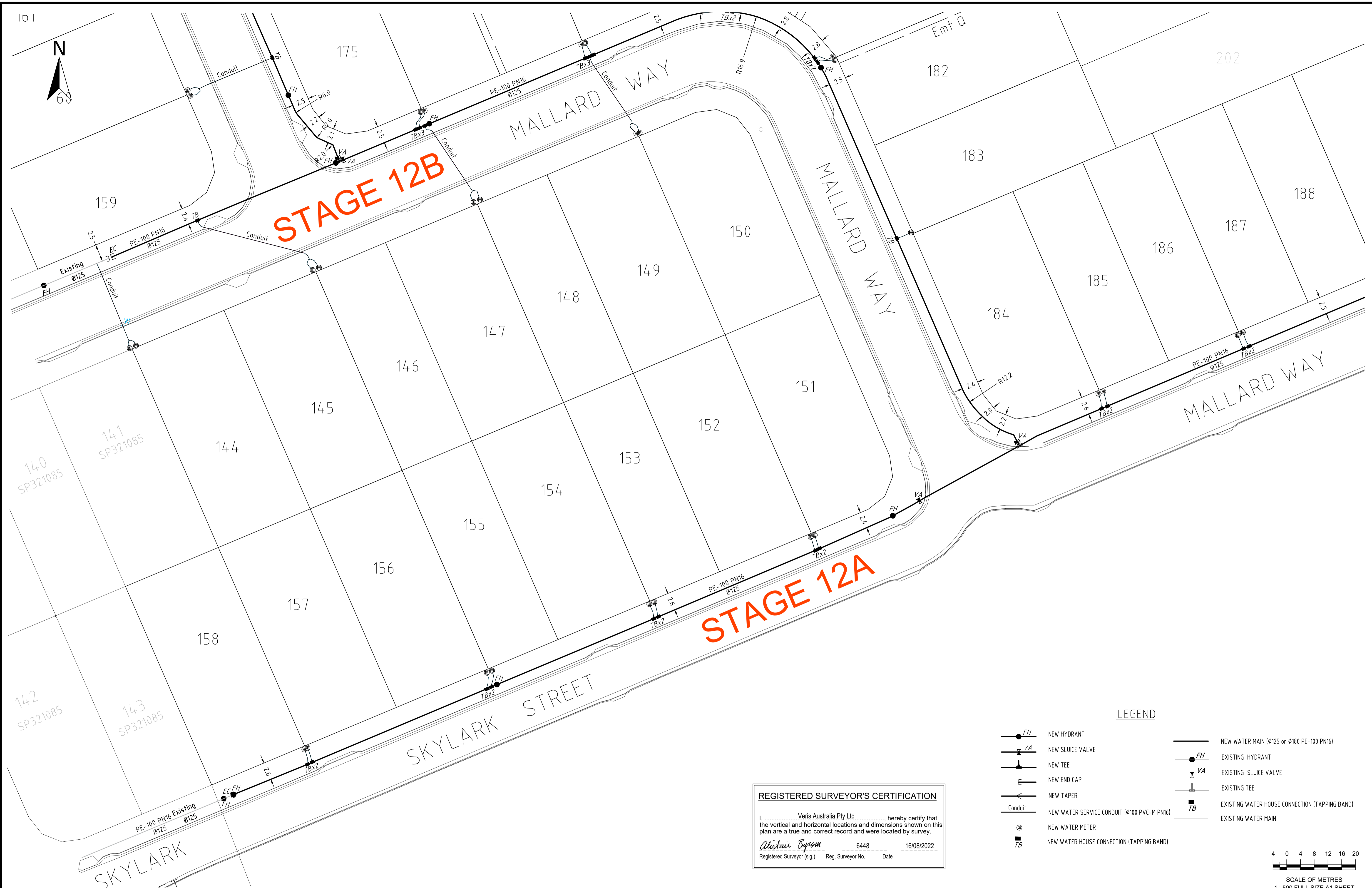

LEGEND

- NEW HYDRANT
- NEW SLUICE VALVE
- NEW TEE
- NEW END CAP
- NEW TAPER
- NEW WATER SERVICE CONDUIT (Ø100 PVC-M PN16)
- NEW WATER METER
- NEW WATER HOUSE CONNECTION (TAPPING BAND)
- EXISTING HYDRANT
- EXISTING SLUICE VALVE
- EXISTING TEE
- EXISTING WATER HOUSE CONNECTION (TAPPING BAND)
- NEW WATER MAIN (Ø125 or Ø180 PE-100 PN16)
- EXISTING WATER MAIN

REGISTERED SURVEYOR'S CERTIFICATION

I, Veris Australia Pty Ltd, hereby certify that the vertical and horizontal locations and dimensions shown on this plan are a true and correct record and were located by survey.

Alister Byron 6448 16/08/2022
 Registered Surveyor (sig.) Reg. Surveyor No. Date



SCALE OF METRES
1 : 500 FULL SIZE A1 SHEET

A1	C	16/08/2022	PROGRESS PLOT	JMc	DRAWN	GJF	18/03/2022
	B	01/07/2022	PROGRESS PLOT	JMc	CHECKED		
	A	18/03/2022	PROGRESS PLOT	GJF	APPROVED		
	REV NO	DATE	REVISION PURPOSE / DESCRIPTION	DRAWN	RPEQ	RPEQ No	INITIALS

veris

BRISBANE (07) 3664 4700 WHITSUNDAYS (07) 4945 6600
 MACKAY (07) 4957 9700 CAIRNS (07) 4252 9400
 veris.com.au
 ACN 615 735 727
 Veris Australia Pty Ltd



BRENTWOOD FOREST
 7000 Jones Road, Bellbird Park
AS CONSTRUCTED WATER STAGE 12
WATER

DRAWING STATUS AS CONSTRUCTED	
SHEET 4 OF 4 SHEETS	
DRAWING NO. 400891-AW12C	REV. C