

**LEGEND**

- SEWER MAIN
- SEWER HOUSE CONNECTION
- SEWER HOUSE CONNECTION
- SEWER MAINTENANCE HOLE (INSITU)
- SEWER MAINTENANCE SHAFT
- SEWER END OF LINE
- EXISTING SEWER MAINTENANCE SHAFT

**REGISTERED SURVEYOR'S CERTIFICATION**

I, Veris Australia Pty Ltd hereby certify that the vertical and horizontal locations and dimensions shown on this plan are a true and correct record and were located by survey.

*Alistair Byrom* 6448 17/08/2022  
 Registered Surveyor (sig.) Reg. Surveyor No. Date

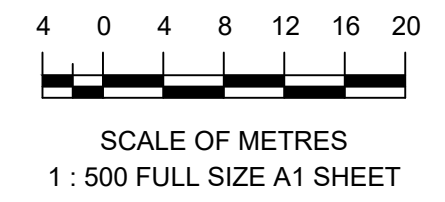

<b>A1</b>	D	04/08/2022	PROGRESS PLOT	JMc				
	C	18/07/2022	PROGRESS PLOT	JMc	DRAWN	GJF	18/02/2022	
	B	11/03/2022	PROGRESS PLOT	GJF	CHECKED			
	A	18/02/2022	PROGRESS PLOT	GJF	APPROVED			
	REV NO	DATE	REVISION PURPOSE / DESCRIPTION	DRAWN	RPEQ	RPEQ No	INITIALS	DATE

**veris** BRISBANE (07) 3069 6700 WHITSUNDAYS (07) 4946 6600  
 MACKAY (07) 4967 6700 CAIRNS (07) 4252 9400  
 veris.com.au  
 ACN 615 730 727  
 Veris Australia Pty Ltd

**QUEENSLAND UrbanUtilities**

**BRENTWOOD FOREST**  
 7000 Jones Road, Bellbird Park  
**AS CONSTRUCTED SEWER STAGE 12**  
**SEWER**

<b>DRAWING STATUS</b> <b>AS CONSTRUCTED</b>	
SHEET 1 OF 4 SHEETS	
DRAWING NO. <b>400891-AS12</b>	REV. <b>D</b>



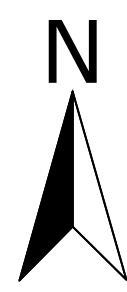
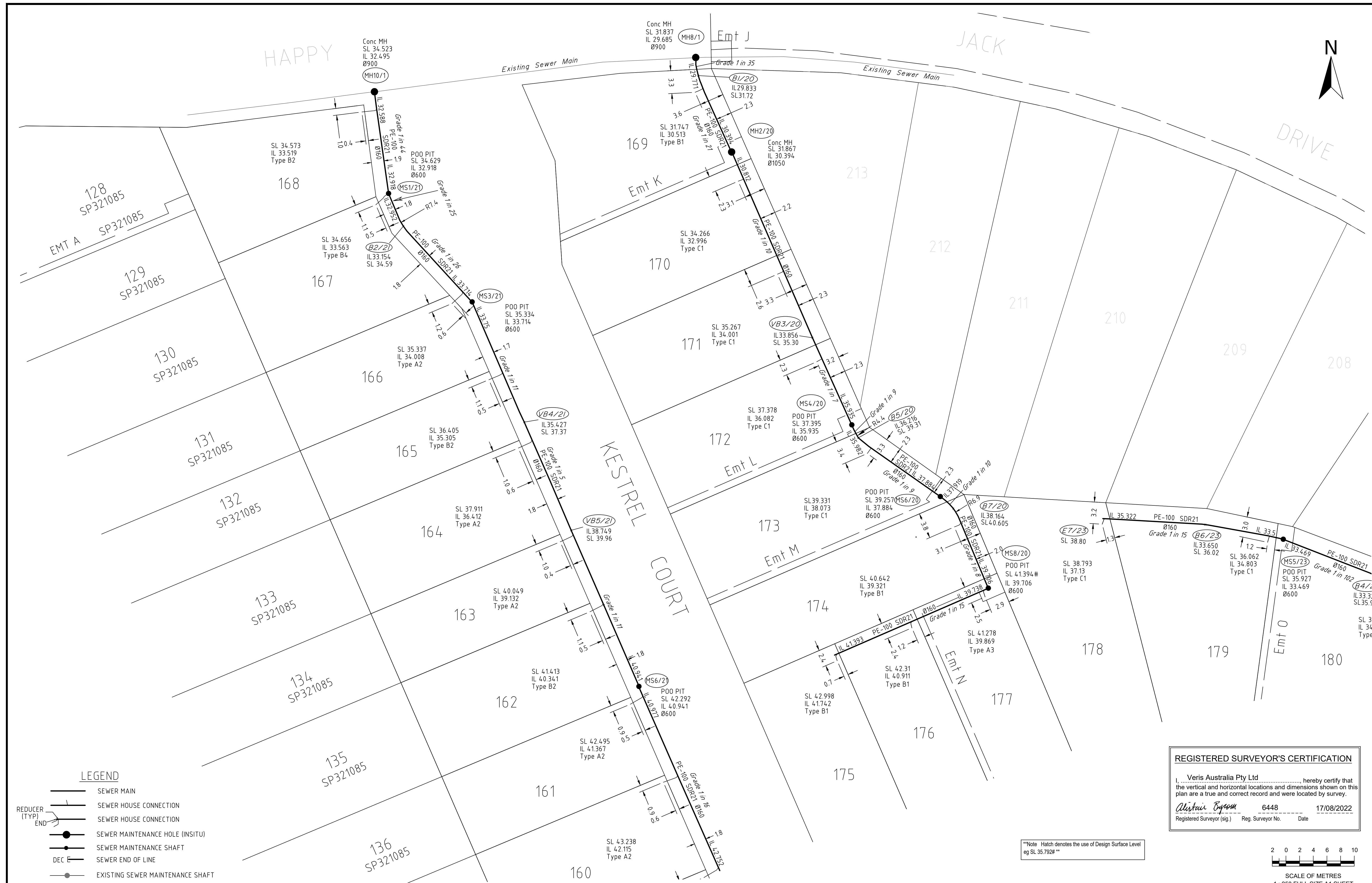

**LEGEND**

- SEWER MAIN
- SEWER HOUSE CONNECTION
- SEWER HOUSE CONNECTION
- SEWER MAINTENANCE HOLE (INSITU)
- SEWER MAINTENANCE SHAFT
- SEWER END OF LINE
- EXISTING SEWER MAINTENANCE SHAFT

**REGISTERED SURVEYOR'S CERTIFICATION**

I, Veris Australia Pty Ltd, hereby certify that the vertical and horizontal locations and dimensions shown on this plan are a true and correct record and were located by survey.

*Alister Byrom* 6448 17/08/2022  
 Registered Surveyor (sig.) Reg. Surveyor No. Date

\*\*Note: Hatch denotes the use of Design Surface Level eg SL 35.792M\*\*

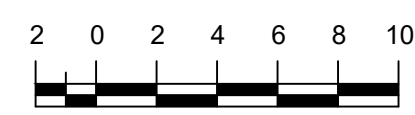

SCALE OF METRES  
1 : 250 FULL SIZE A1 SHEET

A1	D	04/08/2022	PROGRESS PLOT	JMc				
	C	18/07/2022	PROGRESS PLOT	JMc				
	B	11/03/2022	PROGRESS PLOT	GJF				
	A	18/02/2022	PROGRESS PLOT	GJF				
	REV NO	DATE	REVISION PURPOSE / DESCRIPTION	DRAWN	RPEQ	RPEQ No	INITIALS	DATE

BRISBANE WHITSUNDAYS  
 071 3066 6700 071 4042 6000

**veris** MACKAY CAIRNS  
 071 4067 8700 071 4252 9400

veris.com.au  
 ACN 615 730 727  
 Veris Australia Pty Ltd



**BRENTWOOD FOREST**  
 7000 Jones Road, Bellbird Park  
**AS CONSTRUCTED SEWER STAGE 12**  
**SEWER**

DRAWING STATUS <b>AS CONSTRUCTED</b>	
SHEET 2 OF 4 SHEETS	
DRAWING NO. <b>400891-AS12</b>	REV. <b>D</b>



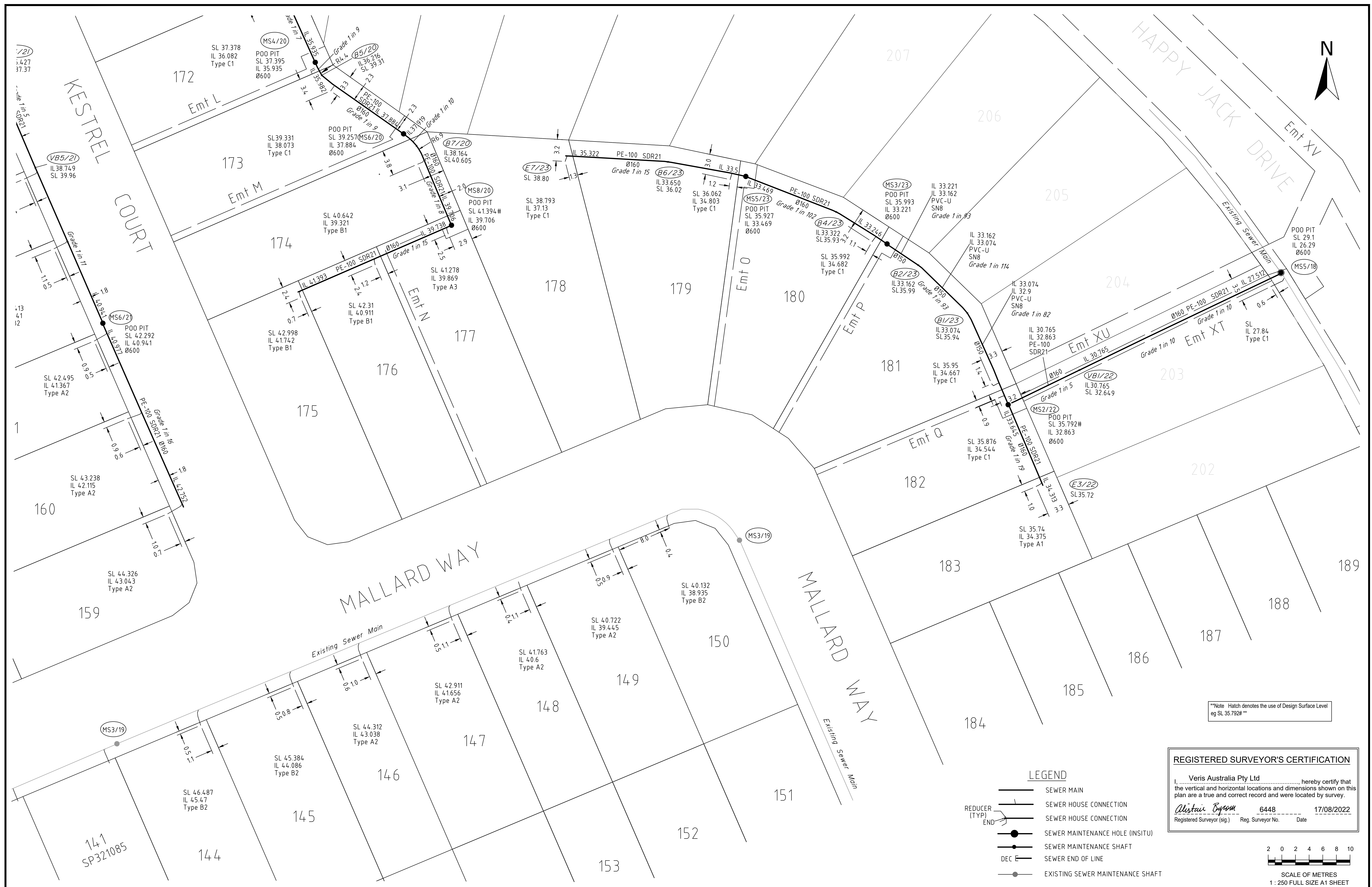

\*\*\*Note Hatch denotes the use of Design Surface Level eg SL 35.792H\*\*\*

**REGISTERED SURVEYOR'S CERTIFICATION**

Veris Australia Pty Ltd hereby certify that the vertical and horizontal locations and dimensions shown on this plan are a true and correct record and were located by survey.

*Alistair Byrom* 6448 17/08/2022  
 Registered Surveyor (sig.) Reg. Surveyor No. Date

- LEGEND**
- SEWER MAIN
  - SEWER HOUSE CONNECTION
  - SEWER END OF LINE
  - SEWER MAINTENANCE HOLE (INSITU)
  - SEWER MAINTENANCE SHAFT
  - EXISTING SEWER MAINTENANCE SHAFT



SCALE OF METRES  
1 : 250 FULL SIZE A1 SHEET

A1	D	04/08/2022	PROGRESS PLOT	JMc				
	C	18/07/2022	PROGRESS PLOT	JMc				
	B	11/03/2022	PROGRESS PLOT	GJF				
	A	18/02/2022	PROGRESS PLOT	GJF				
	REV NO	DATE	REVISION PURPOSE / DESCRIPTION	DRAWN	RPEQ	RPEQ No	INITIALS	DATE

BRISBANE WHITSUNDAYS  
 (07) 3955 8700 (07) 4945 6600

**veris** MACKAY CAIRNS  
 (07) 4957 8700 (07) 4252 9400

veris.com.au  
 ACN 615 735 727  
 Veris Australia Pty Ltd



**BRENTWOOD FOREST**  
 7000 Jones Road, Bellbird Park  
**AS CONSTRUCTED SEWER STAGE 12**  
**SEWER**

DRAWING STATUS <b>AS CONSTRUCTED</b>	
SHEET 3 OF 4 SHEETS	
DRAWING NO. <b>400891-AS12</b>	REV. <b>D</b>



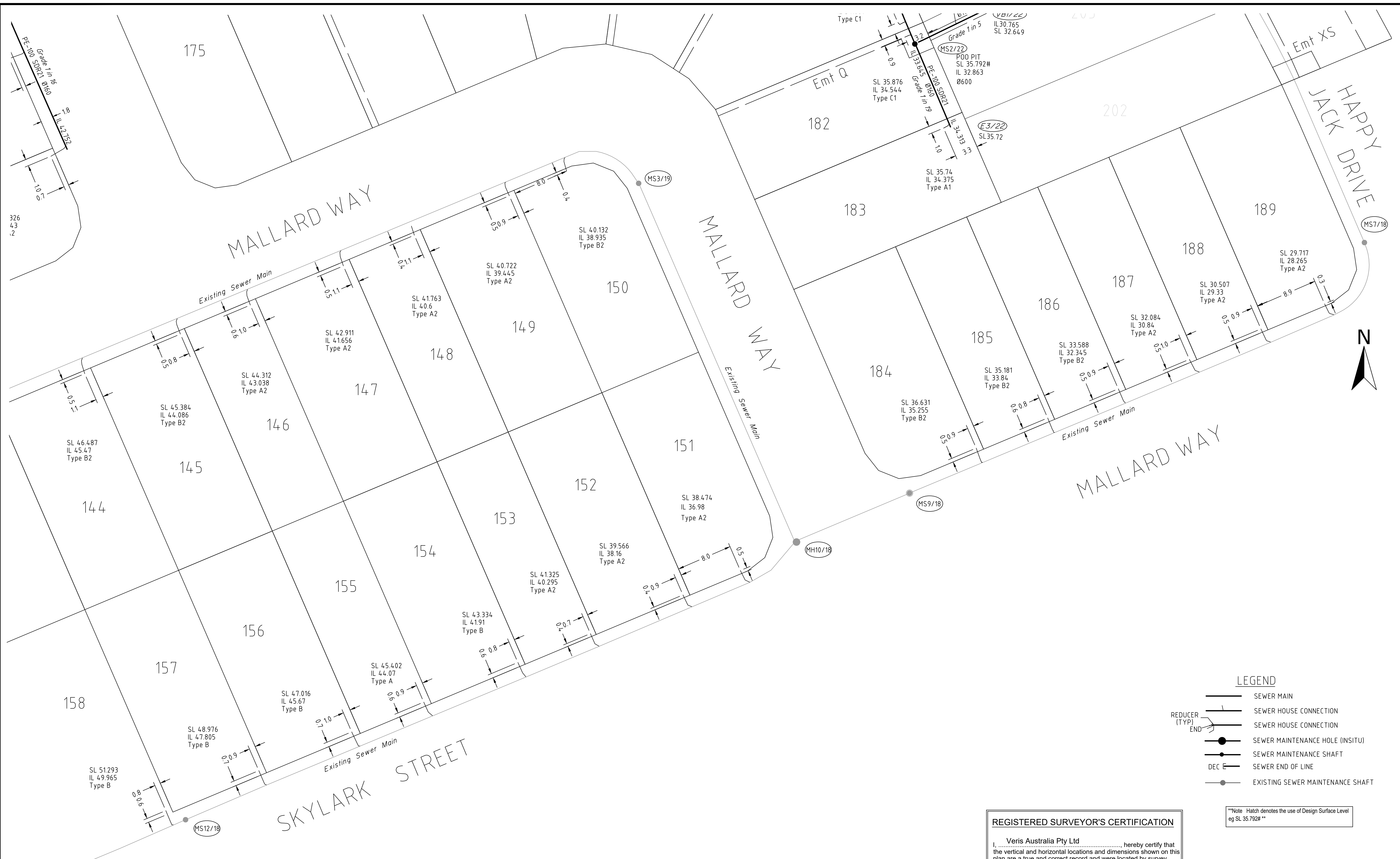

- LEGEND**
- SEWER MAIN
  - SEWER HOUSE CONNECTION
  - SEWER HOUSE CONNECTION
  - SEWER MAINTENANCE HOLE (INSITU)
  - SEWER MAINTENANCE SHAFT
  - SEWER END OF LINE
  - EXISTING SEWER MAINTENANCE SHAFT

\*\*Note: Hatch denotes the use of Design Surface Level  
eg SL 35.792#\*\*

**REGISTERED SURVEYOR'S CERTIFICATION**

I, Veris Australia Pty Ltd, hereby certify that the vertical and horizontal locations and dimensions shown on this plan are a true and correct record and were located by survey.

*Alister Byrom* 6448 17/08/2022  
Registered Surveyor (sig.) Reg. Surveyor No. Date

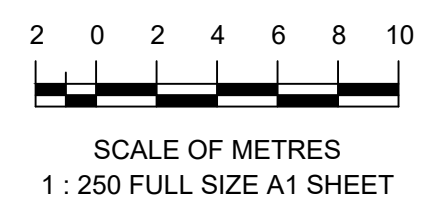

<b>A1</b>	D	04/08/2022	PROGRESS PLOT	JMc				
	C	18/07/2022	PROGRESS PLOT	JMc		DRAWN	GJF	18/02/2022
	B	11/03/2022	PROGRESS PLOT	GJF		CHECKED		
	A	18/02/2022	PROGRESS PLOT	GJF		APPROVED		
	REV NO	DATE	REVISION PURPOSE / DESCRIPTION	DRAWN	RPEQ	RPEQ No	INITIALS	DATE

**veris** BRISBANE (07) 3066 6700 WHITSUNDAYS (07) 4946 6600  
MACKAY (07) 4967 6700 CAIRNS (07) 4252 9400  
veris.com.au  
ACN 615 735 727  
Veris Australia Pty Ltd



**BRENTWOOD FOREST**  
7000 Jones Road, Bellbird Park  
**AS CONSTRUCTED SEWER STAGE 12**  
SEWER

DRAWING STATUS <b>AS CONSTRUCTED</b>	
SHEET 4 OF 4 SHEETS	
DRAWING NO. <b>400891-AS12</b>	REV. <b>D</b>